

Housing and Bracket

Precautions

Precaution for Housing and Bracket

CENDK1112100001

NOTE

When dismantling housing and bracket, inspect mountings and bolts for damage and wear. Replace if necessary.

Service Instructions

Lower Side Cover Components

CENDK1112106001

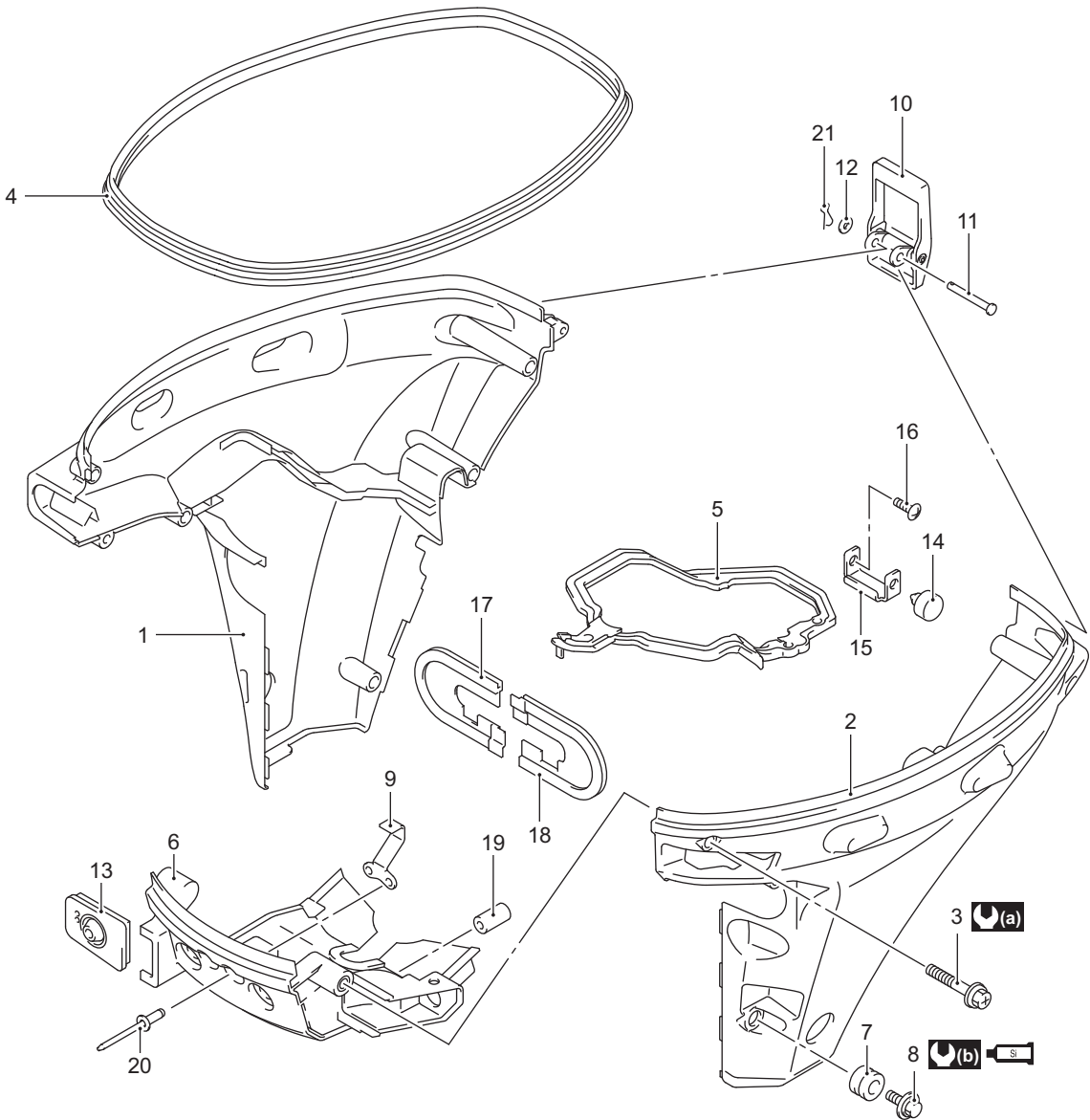

IDK111210024-06

1. Lower side cover STBD	7. Cushion	13. Cable grommet	19. Cushion
2. Lower side cover PORT	8. Screw	14. Cushion	20. Revet
3. Screw	9. Hook	15. Holder	21. Clip
4. Side cover rubber	10. Fastener	16. Screw	(a) : 5 N·m (0.5 kgf-m, 3.6 lbf-ft)
5. Side cover seal	11. Pin	17. Upper mount seal STBD	(b) : 5 N·m (0.5 kgf-m, 3.6 lbf-ft)
6. Front panel	12. Washer	18. Upper mount seal PORT	(c) : Apply SUZUKI Silicone seal

2A-2 Housing and Bracket:

Lower Side Cover Removal and Installation

CENDK1112106002

Removal

- 1) Remove the side cover rubber (1).

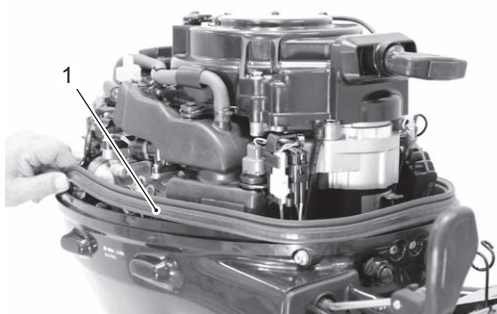

IDK111210025-01

- 2) Remove the snap pin (2), washer (3), pin (4) and fastener (5).

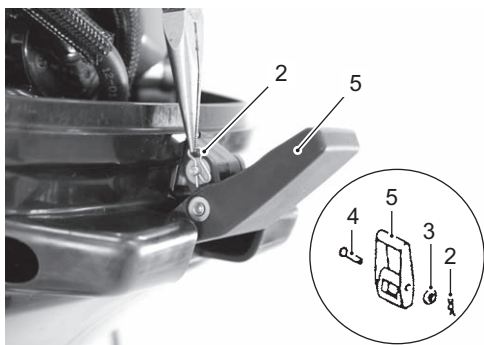

IDK111210026-01

- 3) Remove the seven screws (6) and STBD side cover (7).

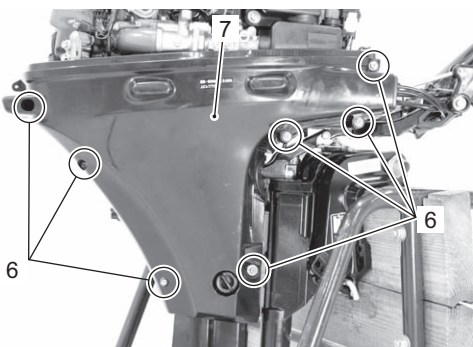

IDK111210027-01

- 4) Remove three screws (8) and PORT lower side cover (9).

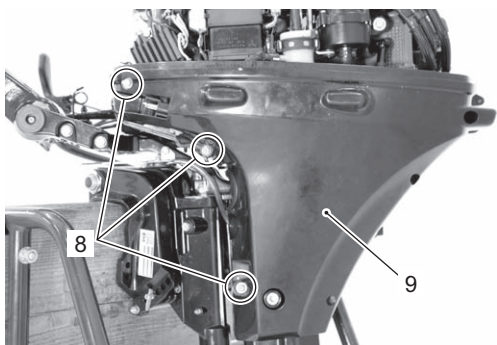

IDK111210028-01

Installation

Installation is reverse order of removal with special attention to the following step.

NOTE

Apply sealant to the two screws "A" of the side cover screw only.

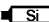
 : Sealant 93691-80030 (SUZUKI Silicone Seal (100 g))

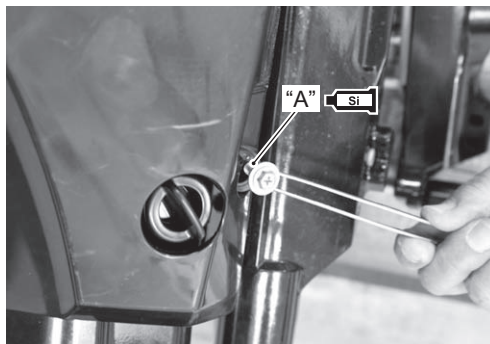

IDK111210029-01

- Tighten side cover screws to specified torque.

Tightening torque

Side cover screw: 5 N·m (0.5 kgf-m, 3.6 lbf-ft)

Tiller Handle and Handle Bracket Removal and Installation

CENDK1112106003

Removal

- 1) Remove both lower side covers.
Refer to "Lower Side Cover Removal and Installation" (Page 2A-2).
- 2) Disconnect the stop switch lead wire connector (1).
Cut the cable tie (2) binding the stop switch lead wire.

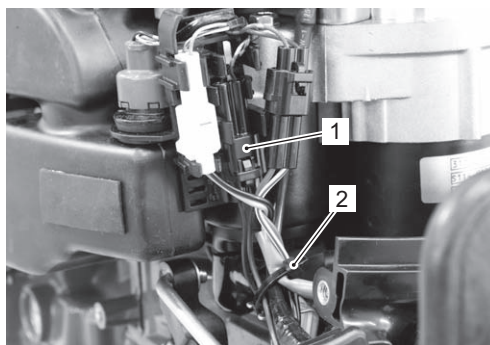

IDK111210030-01

- 3) Loosen the bolt (3) securing shift lever (4).
Remove the bolt (3), shift lever (4), washer (5), washer (6), wave washers (7) and spacer (8).

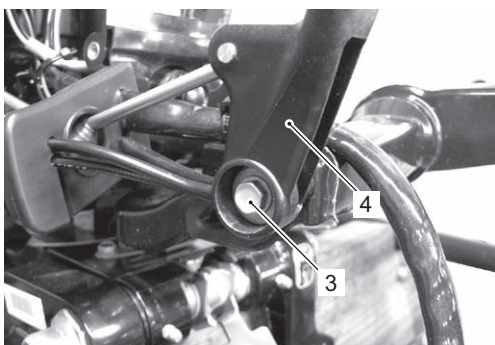

IDK111210017-01

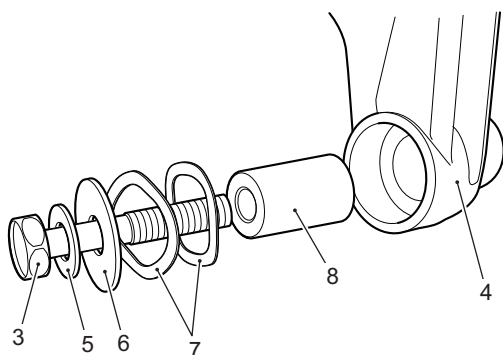

IDK111210023-01

- 4) Loosen the throttle cable lock nuts (9).
Remove the throttle cables (10) from throttle drum and cable bracket.

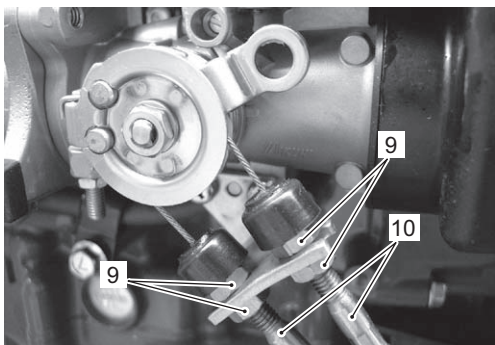

IDK111210018-02

- 5) Loosen the cable clamp (11) and remove the battery cable (12) from handle bracket.

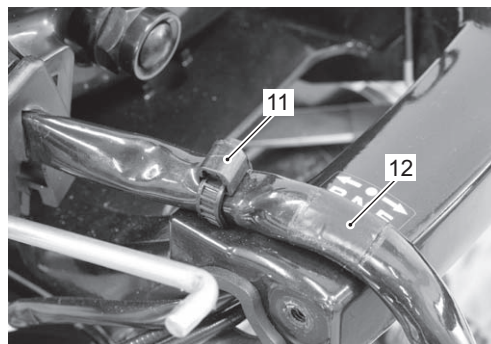

IDK111210031-02

- 6) Remove the bolts (13) securing handle bracket to steering bracket.
Remove the tiller handle and handle bracket assembly.

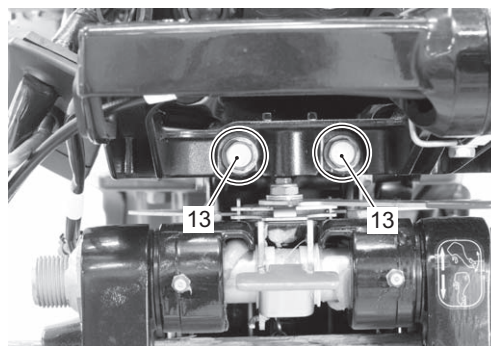

IDK111210022-02

- 7) Remove the bolts (14) and tiller handle cover (15).
Remove the tiller handle (16) and cable assembly.

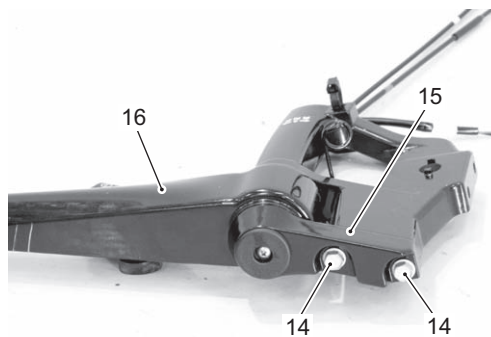

IDK111210032-01

2A-4 Housing and Bracket:

Installation

Installation is reverse order of removal with special attention to the following steps.

Tiller handle

- Place bush (1), friction rubber (2) and bush (3) on tiller handle.

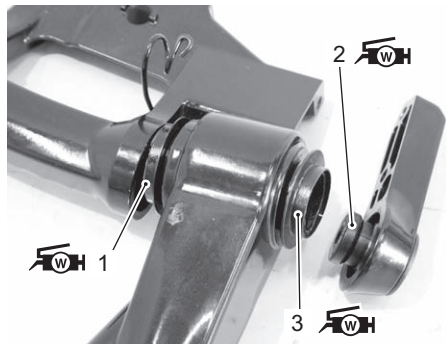

IDK111210033-03

- Install the tiller handle (4) and handle cover (5).

NOTE

Before installing tiller handle cover, check that lead wire and cable routing properly.

- Tighten handle cover bolts to the specified torque.

Tightening torque

Tiller handle bolt (a): 23 N·m (2.3 kgf-m, 16.5 lbf-ft)

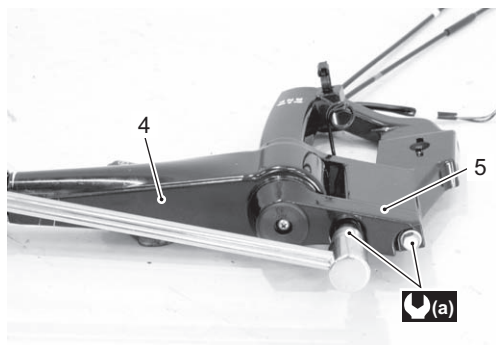

IDK111210034-02

Handle bracket

- Install the handle bracket and tiller handle assembly (1).
- Tighten handle bracket bolt, pre-coated with thread lock, to the specified torque.

Tightening torque

Tiller handle bracket bolt (a): 23 N·m (2.3 kgf-m, 16.5 lbf-ft)

1342 : Thread lock cement 99000-32050 (SUZUKI Thread Lock 1342 (50 g))

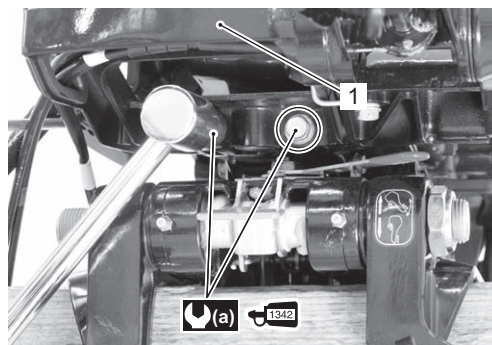

IDK111210035-01

Throttle cables

- Install the throttle cables (1) to throttle drum and cable bracket (2), then tighten nuts (3) securely.
- Adjust of throttle control cable.
Refer to "Throttle Control Cable Installation and Adjustment" (Page 2A-5).

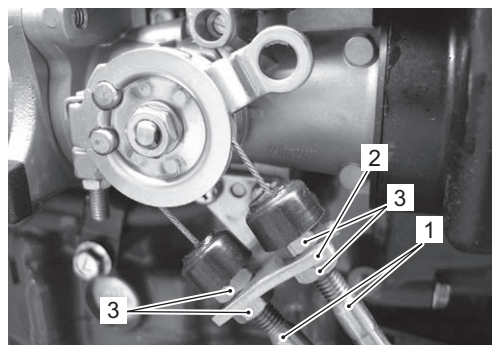

IDK111210020-02

Final assembly check

- Perform the following final assembly checks to ensure proper and safe operation of the repaired unit.
 - All parts removed have been returned to their original positions.
 - Wire routing matches service manual illustration. Refer to "Wiring Harness Routing Diagram" in Section 4A (Page 4A-3).

Throttle Control Cable Installation and Adjustment

CENDK1112106004

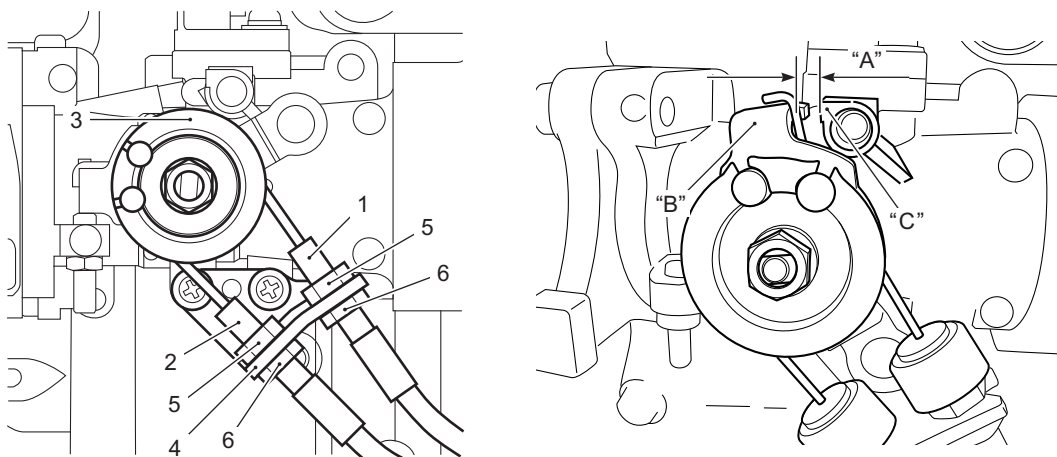

IDK111210021-03

"A": Clearance (Max. 2.5 mm)

"B": Lever

"C": Stopper

- 1) Turn the throttle control grip its completely closed position.
- 2) Fit two throttle control cables, (1) and (2) both to the throttle drum (3) and cable holder (4).
- 3) Temporarily tighten the cable lock nut (5) and (6).
- 4) Check cable for tension.
If cable is too tight or too loose, adjust it by adjusting lock nut.
- 5) Secure the throttle control cable (1) and (2) on the cable holder by tightening lock nuts.
- 6) Make sure the clearance "A" exists between the lever "B" and the stopper "C" with throttle control fully opened.
If not, adjust again.
- 7) Operate the throttle control grip and check that the throttle valve opens and closes completely without interference.

NOTE

If the throttle valve does not operate smoothly or open/close completely, check for the throttle cable routing or inner cable tension.

Steering Friction Adjuster Disassembly and Assembly

CENDK1112106005

Disassembly

Removal

- 1) Remove both lower side covers.
Refer to "Lower Side Cover Removal and Installation" (Page 2A-2).

- 2) Remove the two bolts (1) securing handle bracket.

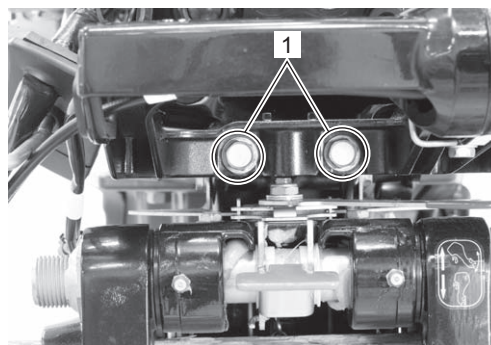

IDK111210036-01

2A-6 Housing and Bracket:

- 3) Remove the two bolts (2) securing steering adjuster plate (3).
Remove the two bolts (4) securing steering adjuster base plate (5).

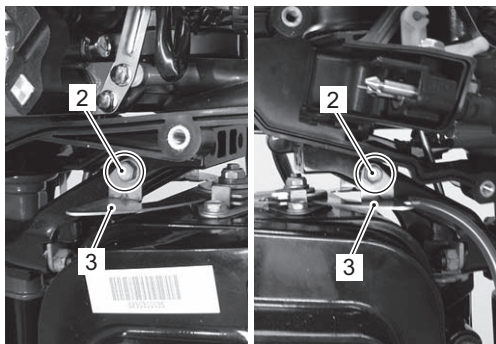

IDK111210037-01

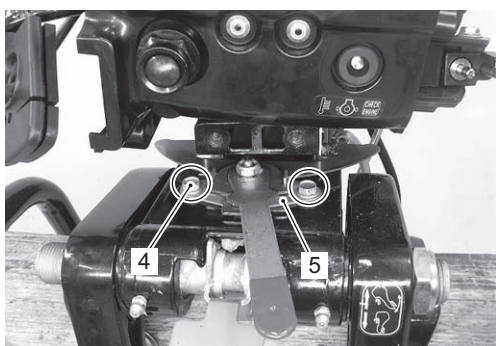

IDK111210038-01

- 4) Remove the steering friction adjuster assembly (6).

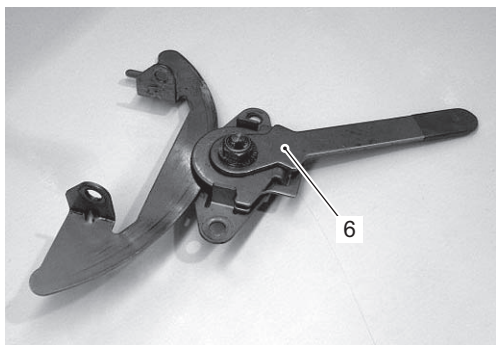

IDK111210039-01

Disassembly

- 1) Remove the steering adjuster plate (1).

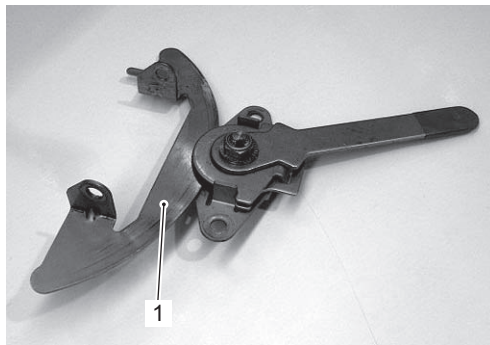

IDK111210040-01

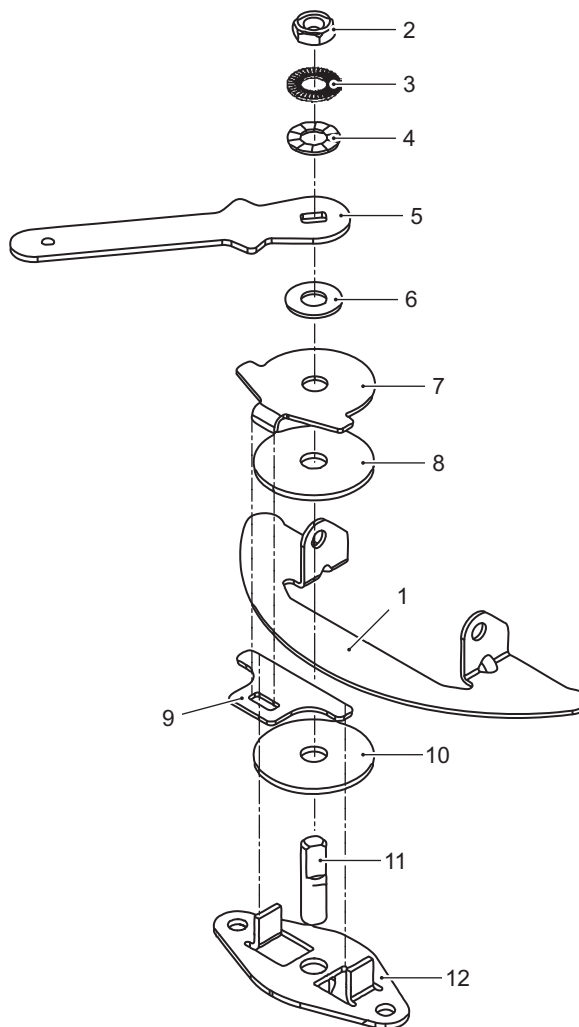

IDK111210003-02

- 2) Remove the friction adjuster nut (2), washer (3), washer (4) and adjuster lever (5).
- 3) Remove the washer (6) and upper plate (7).
- 4) Remove the friction washer (8) and spacer (9).
- 5) Remove the friction washer (10).
Loosen and remove the shaft (11) from adjuster base plate (12).

Assembly

Assemble the steering friction adjuster set in the following sequence:

Reassembly

- 1) Thread the shaft (1) to the adjuster base plate (2) as shown in the figure.

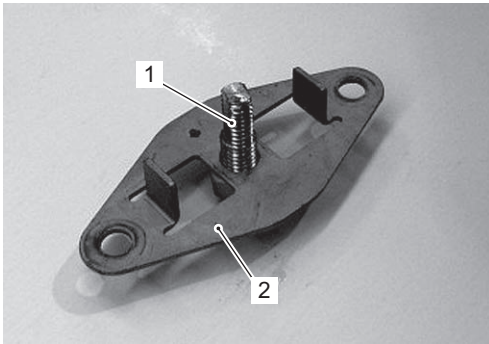

IDK111210041-01

- 2) Install the friction washer (3), spacer (4) and friction washer (5).

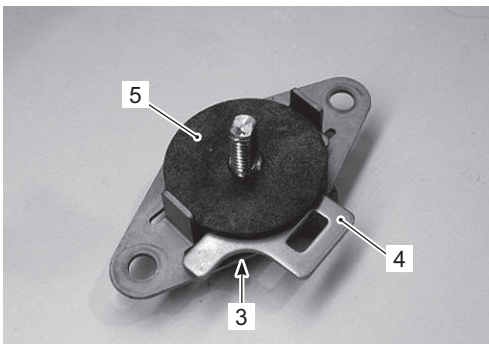

IDK111210042-01

- 3) Install the upper plate (6) and washer (7).

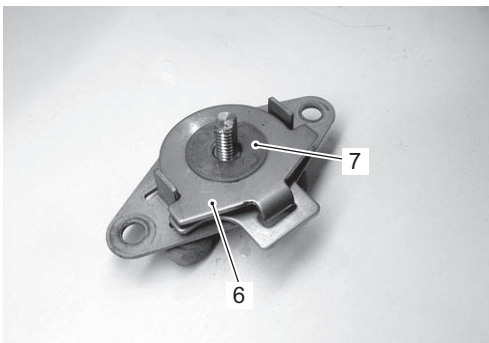

IDK111210043-01

- 4) Install the steering adjuster lever (8), washer (9) and washer (10).

NOTE

When install the washer (9) and (10), put rough face of each washer together.

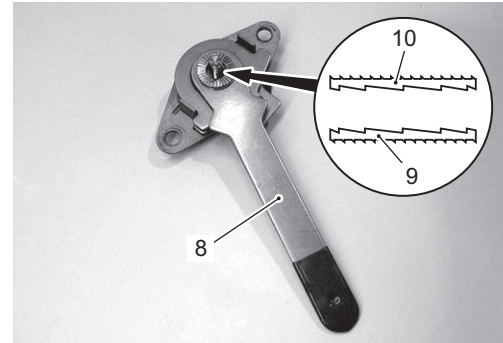

IDK111210044-01

- 5) Place the steering adjuster plate (11) between the friction washer (3) and (5).

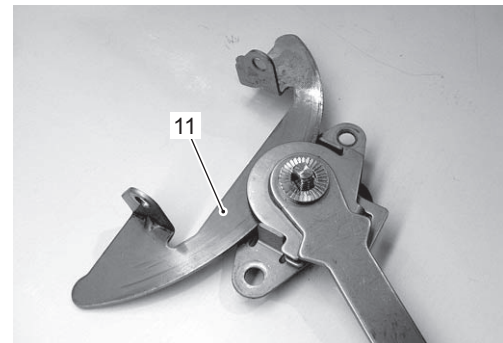

IDK111210045-02

- 6) Install the friction adjuster nut (12).
Move the steering adjuster lever to fully left position. Tighten the friction adjuster nut (12) to specified torque.

Tightening torque

Steering friction adjuster nut (a): 9 N·m (0.9 kgf-m, 6.5 lbf-ft)



IDK111210046-01

2A-8 Housing and Bracket:

Installation

- 1) Place the steering friction adjuster assembly into position.
- 2) Apply Thread Lock 1342 to the threads of adjuster mounting bolts before threading it.
- 3) Temporarily tighten all mounting bolts.
- 4) Tighten the bolts (1) to specified torque.

Tightening torque

Bolt (a): 10 N·m (1.0 kgf-m, 7.2 lbf-ft)

- 5) Move the steering adjuster lever to fully left position. Tighten the bolt (2) and, next, tighten bolt (3) to specified torque.

Tightening torque

Bolt (b): 10 N·m (1.0 kgf-m, 7.2 lbf-ft)

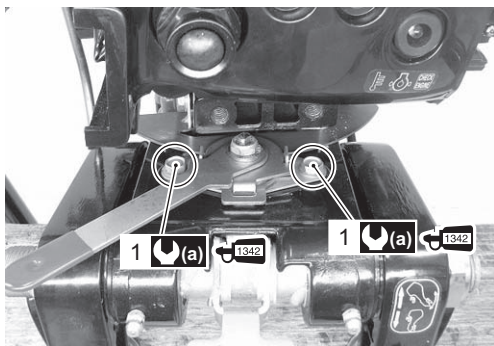

IDK111210047-01

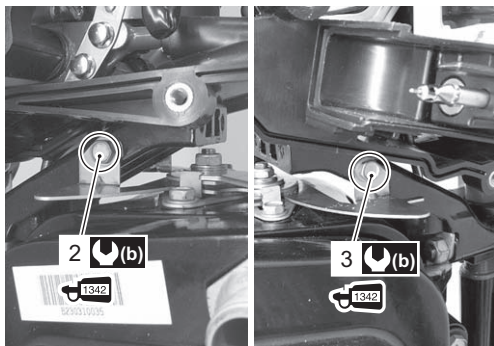



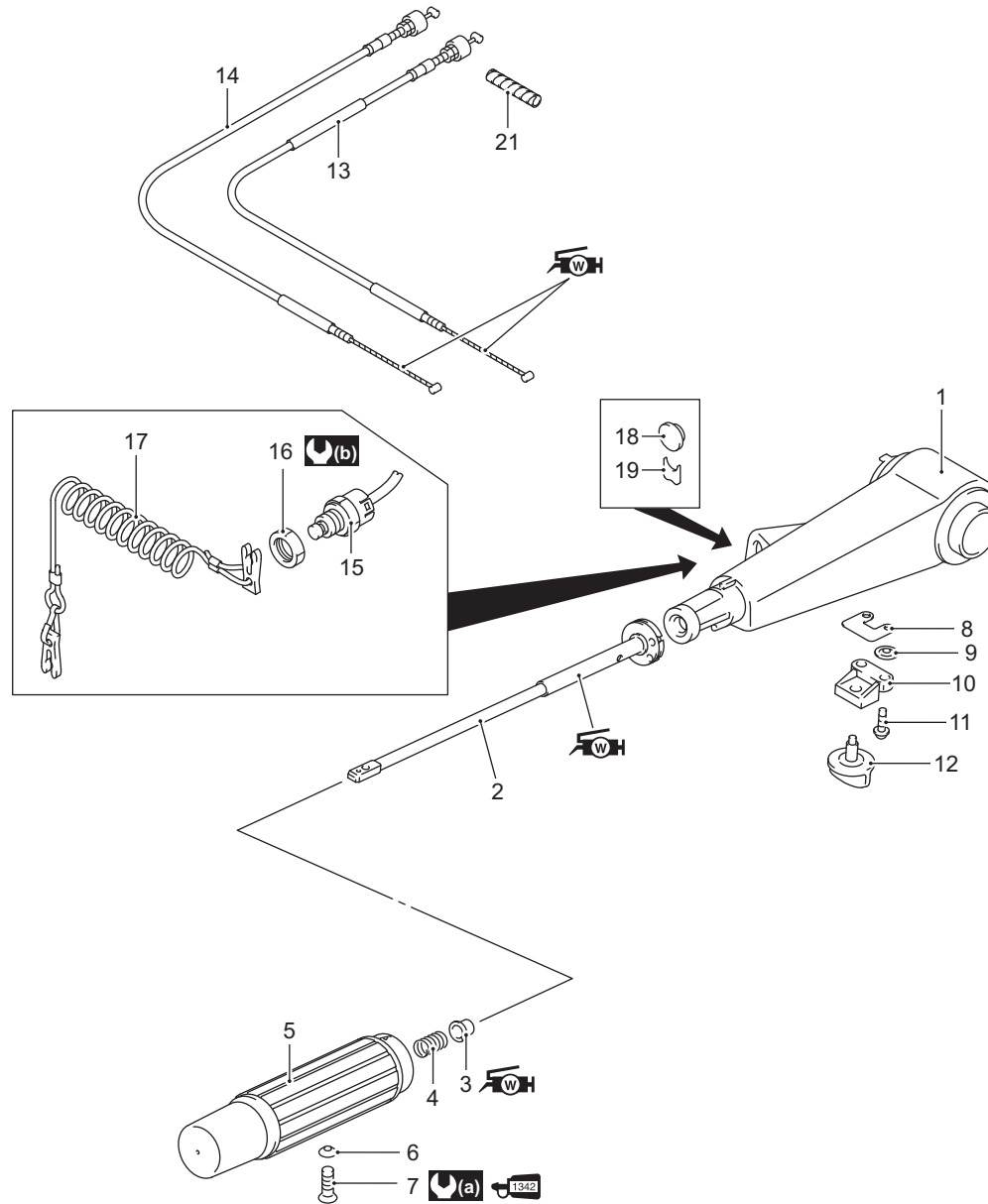

IDK111210048-01

- 6) Install the handle bracket. Refer to "Tiller Handle and Handle Bracket Removal and Installation" (Page 2A-2).



IDK111210049-01

1. Tiller handle	7. Screw	13. Throttle cable	19. Plate
2. handle rod	8. Plate	14. Throttle cable	 (a) : 3 N·m (0.3 kgf-m, 2.1 lbf-ft)
3. Bush	9. Nut	15. Emergency / Stop switch	 (b) : 1.8 N·m (0.18 kgf-m, 1.3 lbf-ft)
4. Spring	10. Support	16. Nut	 (c) : Apply SUZUKI water resistance grease.
5. Handle grip	11. Screw	17. Lock plate	 (d) : Apply SUZUKI thread lock 1342.
6. Lock washer	12. Knob	18. Cap	

Tiller Handle Disassembly and Assembly

CENDK1112106007

Disassembly

- 1) Remove the screw (1) and throttle grip (2).

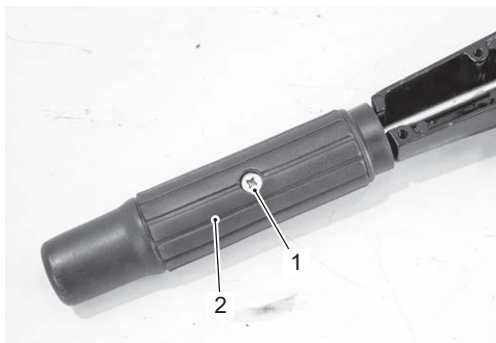

IDK111210050-01

- 2) Remove the screw (3), throttle adjuster knob (4) and lower plate (5).

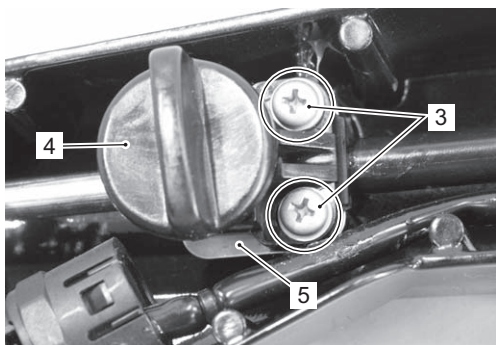

IDK111210051-01

- 3) Remove the spring (6) and bush (7) from handle rod.

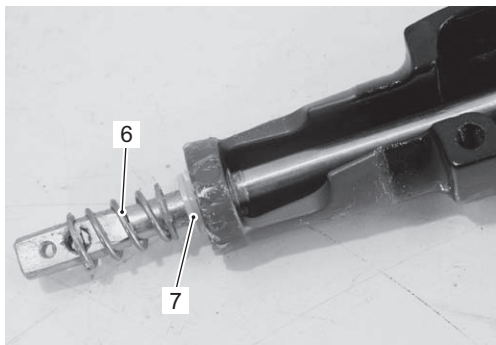

IDK111210052-01

- 4) Remove the handle rod (8) and throttle cable assembly. Remove the throttle cables (9) from throttle rod.

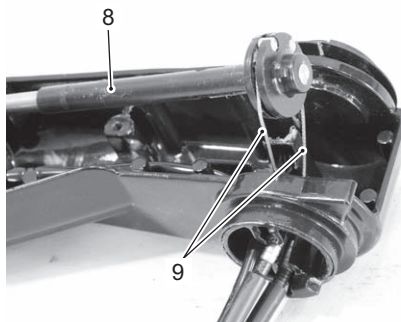

IDK111210053-01

Assembly

Assembly is in the reverse order of disassembly with special attention to the following steps. Reassemble the tiller handle, refer to "Tiller Handle Components" (Page 2A-9).

- 1) Install the throttle cables (1) to throttle rod.

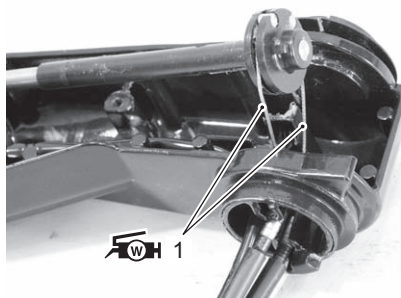

IDK111210054-01

- 2) Place the throttle rod/cable assembly into position.

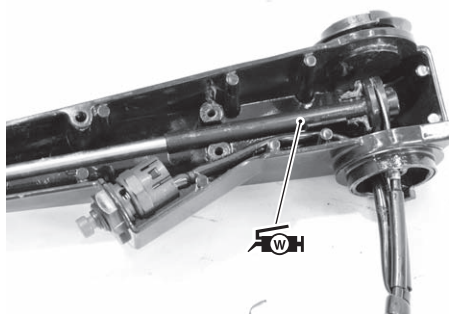

IDK111210055-01

- 3) Insert the bush (3) to tiller handle and install spring (4) to handle rod.

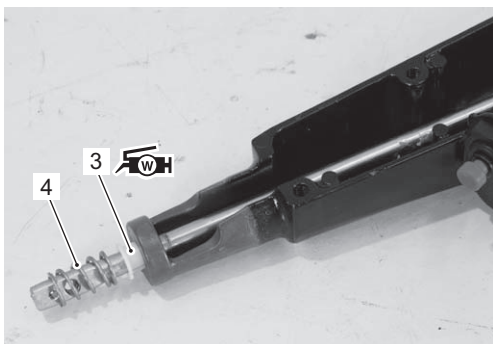

IDK111210056-01

- 4) Install the lower plate (5), throttle adjuster knob (6), then securely tighten it with screws.

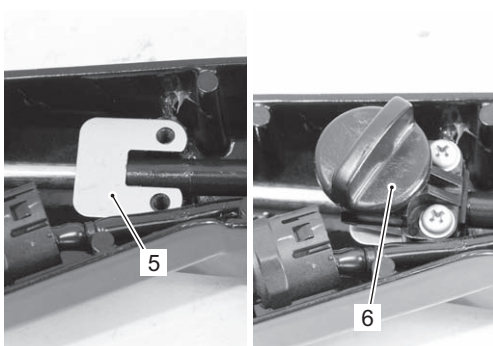

IDK111210058-01

- 5) Install the throttle grip (7), then tighten screw (8), pre-coated with thread lock, to specified torque.

Tightening torque

Throttle grip screw (a): 3 N·m (0.3 kgf-m, 2.1 lbf-ft)

 1342 : Thread lock cement 99000-32050 (SUZUKI Thread Lock 1342 (50 g))

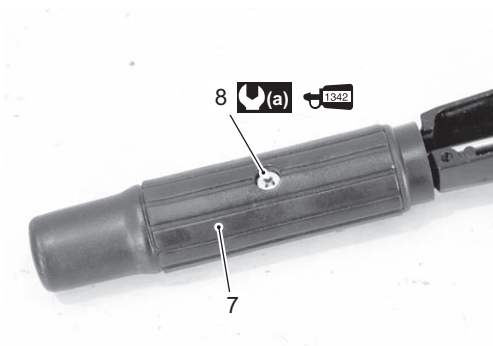

IDK111210059-01

Engine Holder / Driveshaft Housing / Mounts Components

CENDK1112106008

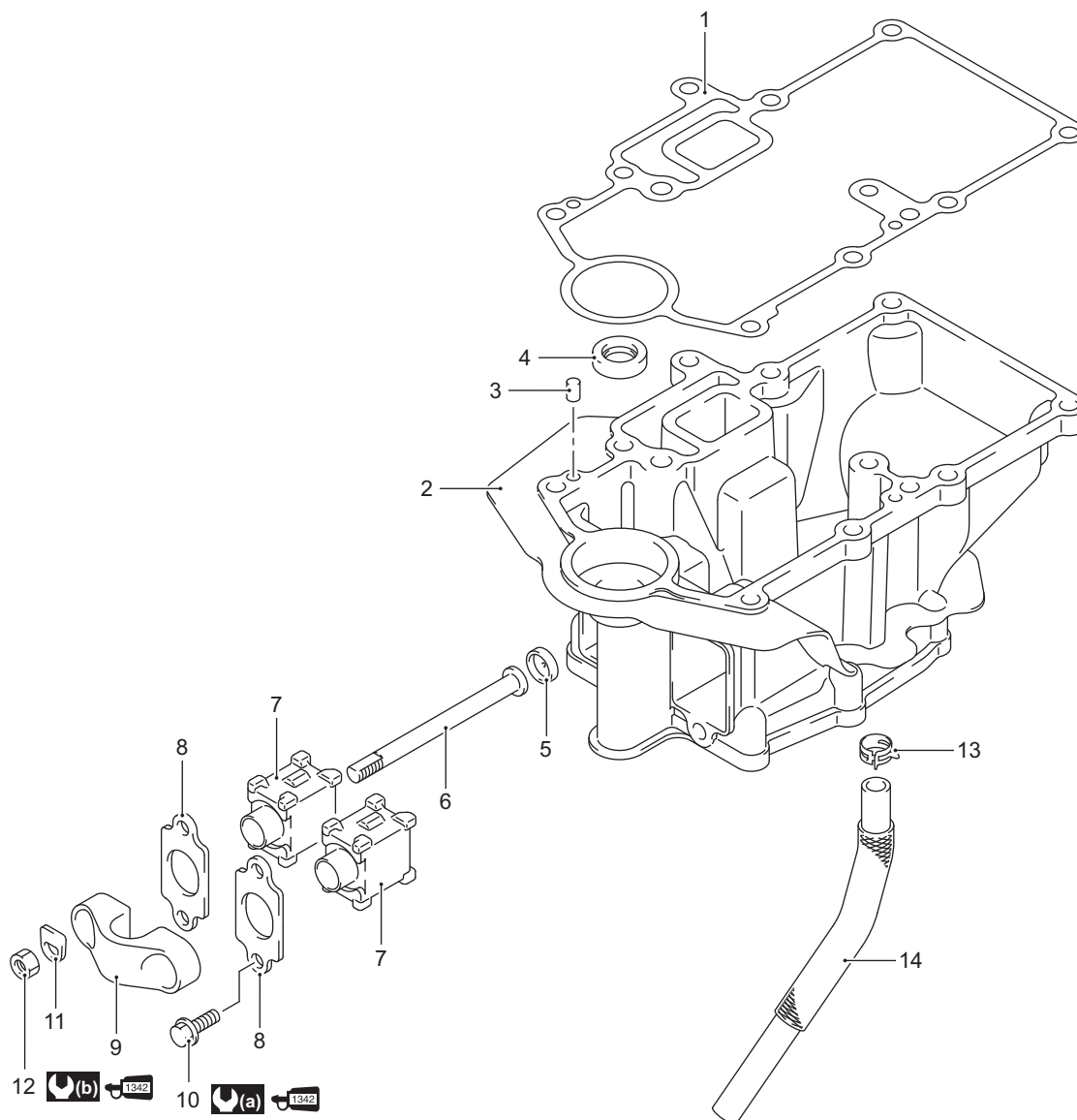

IDK111210060-02

1. Gasket	6. Upper mount bolt	11. Washer	(b) : 35 N-m (3.5 kgf-m, 25.0 lbf-ft)
2. Engine holder	7. Upper mount	12. Upper mount nut	1342 : Apply SUZUKI thread lock 1342.
3. Dowel pin	8. Mount cover	13. Clip	
4. Driveshaft upper oil seal	9. Upper side mount	14. Oil hose	
5. Thrust stopper	10. Bolt	(a) : 23 N-m (2.3 kgf-m, 16.5 lbf-ft)	

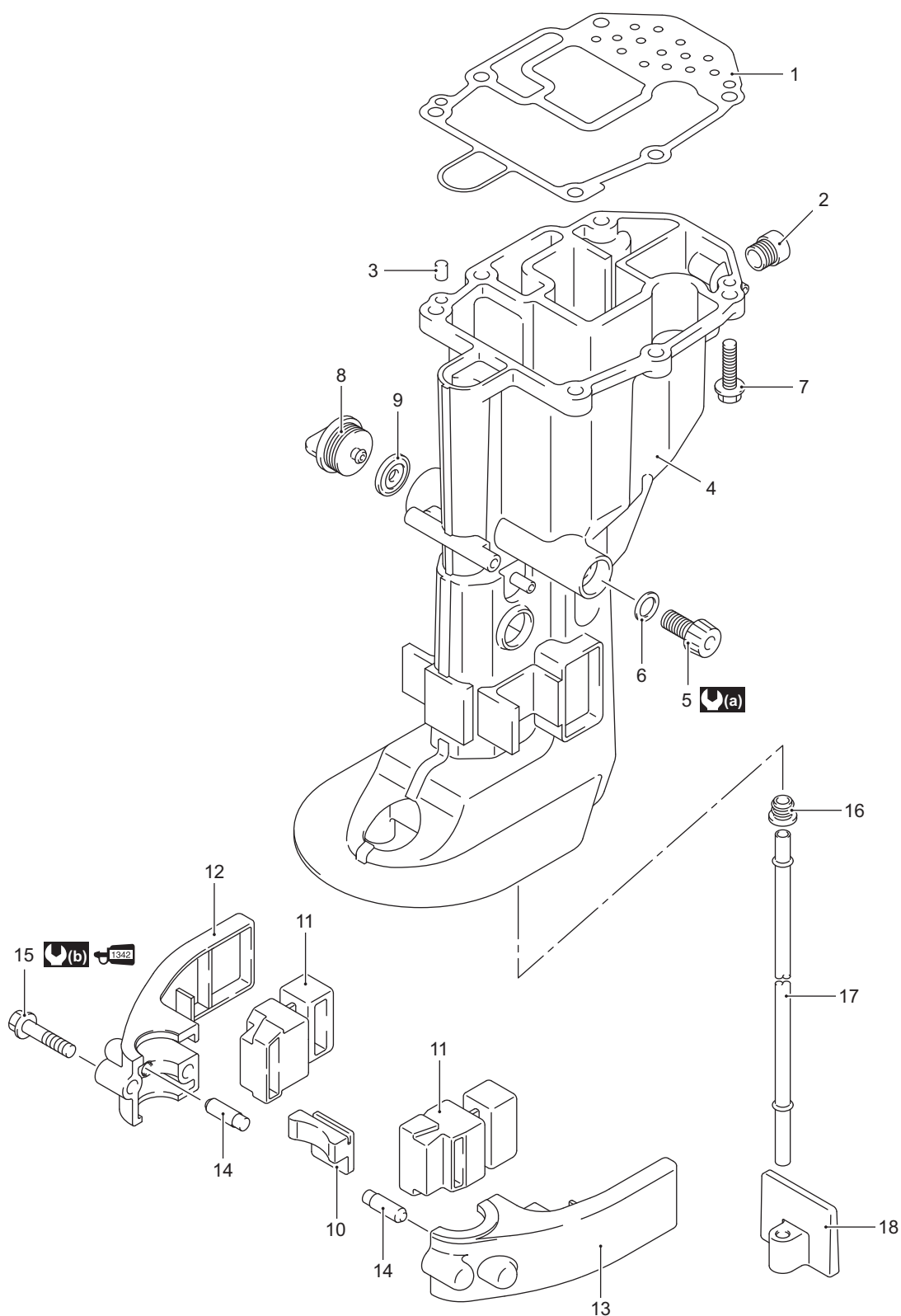

IDK111210061-01

1. Gasket	7. Bolt	13. Lower mount cover PORT	(a) : 13 N-m (1.3 kgf-m, 9.5 lbf-ft)
2. Exhaust pipe	8. Water plug	14. Pin	(b) : 23 N-m (2.3 kgf-m, 16.5 lbf-ft)
3. Dowel pin	9. Gasket	15. Lower mount cover bolt	1342 : Apply SUZUKI thread lock 1342.
4. Driveshaft housing	10. Lower thrust mount	16. Grommet	
5. Oil drain plug	11. Lower side mount	17. Water tube	
6. Gasket	12. Lower mount cover STBD	18. Water tube guide	

2A-14 Housing and Bracket:

Engine Holder / Driveshaft Housing / Mounts Disassembly

CENDK1112106009

- 1) Remove the power unit.
Refer to "Power Unit Removal and Installation" in Section 1D (Page 1D-8).
- 2) Remove the lower unit.
Refer to "Lower Unit Removal and Installation" in Section 3A (Page 3A-5).
- 3) Remove the side cover seal (1).

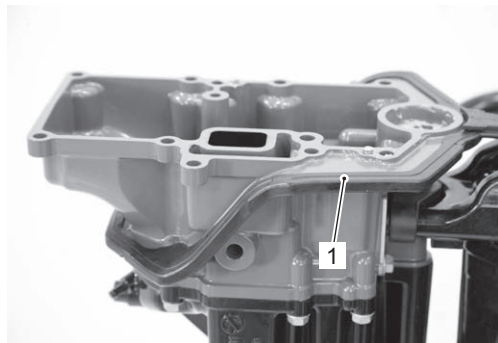

IDK111210062-01

- 4) Remove the two bolts (2) securing PORT/ STBD lower mount covers.

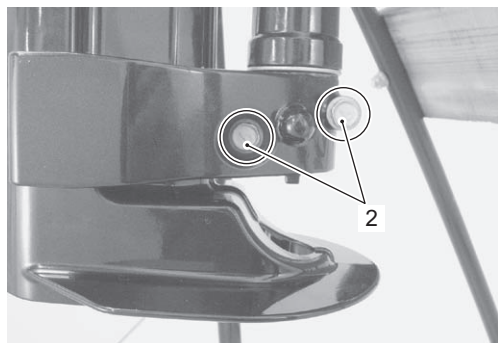

IDK111210004-01

- 5) Remove the STBD lower mount cover (3), lower side mount (4) and lower thrust mount (5).

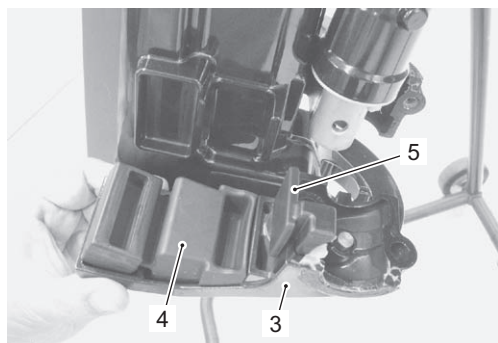

IDK111210005-01

- 6) Remove the PORT lower mount cover (6), lower side mount (7) and pilot shaft washer (8).

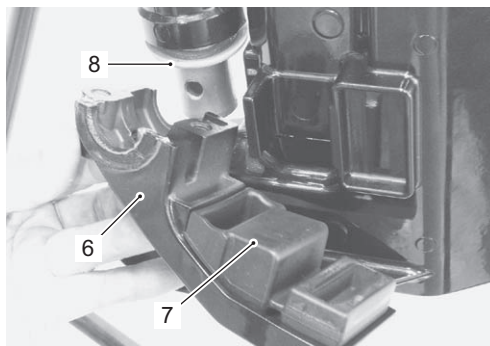

IDK111210006-01

- 7) On PORT/STBD both sides:
Remove the bolts (9) securing upper mount covers (10).

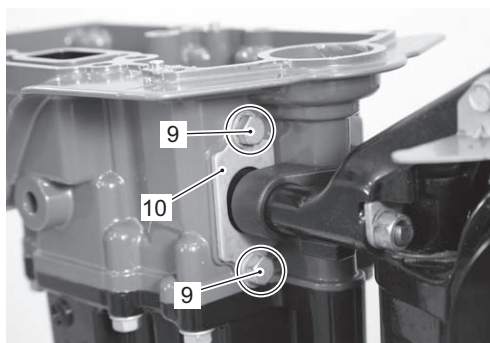

IDK111210063-01

- 8) Remove engine holder and driveshaft housing assembly.

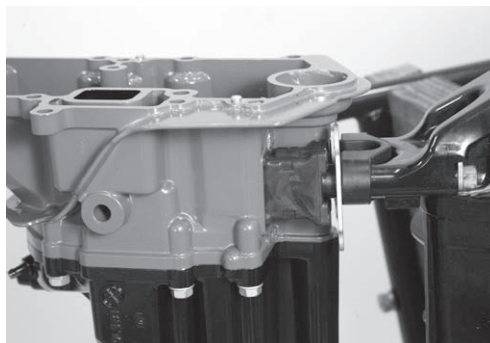

IDK111210064-01

- 9) Remove STBD/PORT upper mount nuts (11) and washers (12).

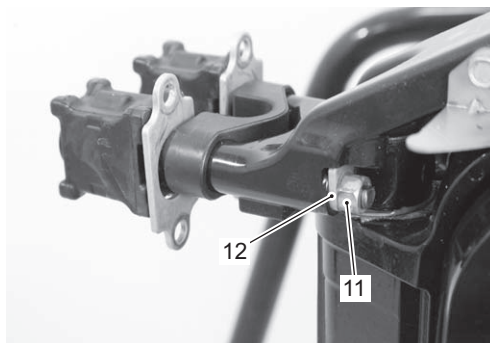

IDK111210065-01

- 10) Remove the upper mount bolts (13), upper mount cover (10), upper mount (14) and thrust stopper (15).

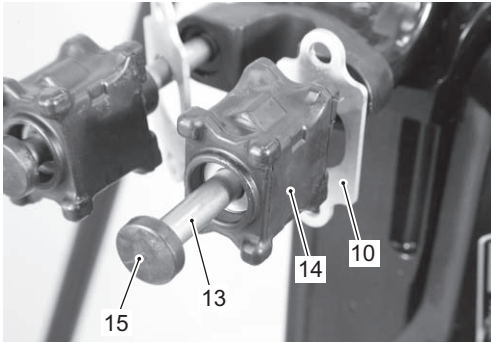

IDK111210066-01

- 11) Remove the upper side mount (16).

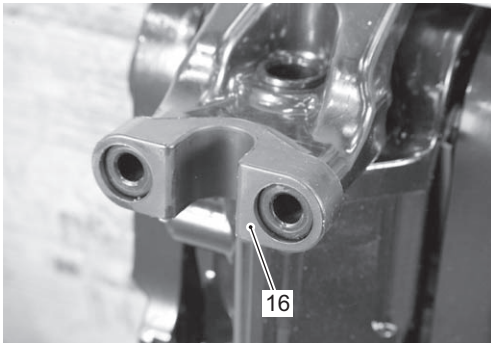

IDK111210008-02

- 12) Remove the six bolts and the engine holder (17) from the driveshaft housing.



IDK111210067-01

- 13) Loosen the clip securing oil hose (18), then remove the oil hose from engine holder.

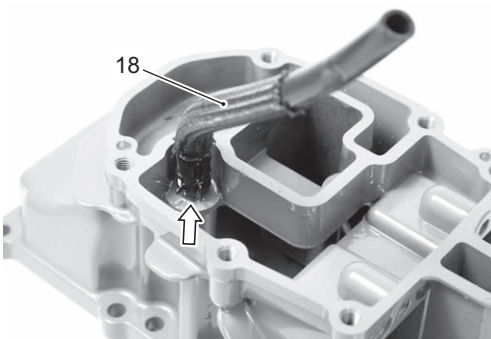

IDK111210068-01

- 14) Remove the water tube guide (19), water tube (20) and water tube grommet (21).

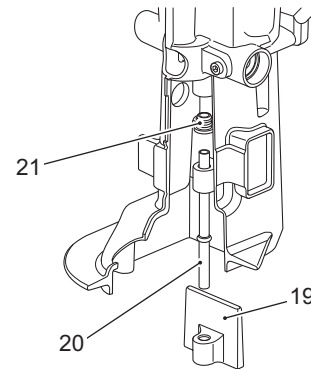

IDK111210012-01

Engine Holder / Driveshaft Housing / Mounts Assembly

CENDK1112106010

Assembly is in reverse order of disassembly with special attention to the following steps.

Engine Holder to Driveshaft Housing

- Apply water resistant grease to water tube grommet (1), then install the water tube grommet to driveshaft housing.

 **Grease 99000-25350 (SUZUKI Water Resistant Grease EP2 (250 g))**

- Install the water tube (2) and water tube guide (3).

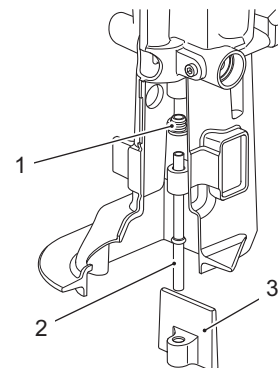

IAJ311210006-02

- Install the oil hose (4), then secure it with clip (5).

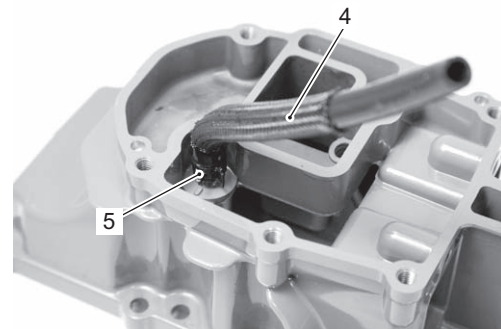

IDK111210069-01

2A-16 Housing and Bracket:

- Install two dowel pins (6) and gasket (7) to driveshaft housing.

NOTICE

Previously used gasket may leak oil and/or cooling water, resulting in engine damage.

Do not reuse gasket. Always assemble with a new gasket.

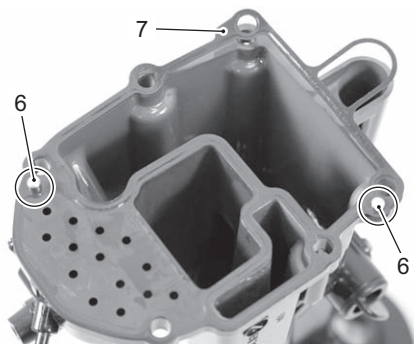

IDK111210070-01

- Install engine holder (8) to driveshaft housing (9). Apply engine oil to the driveshaft housing bolts (10) before threading it. Tighten driveshaft housing bolts to specified torque.

Tightening torque

Driveshaft housing bolt (a): 23 N·m (2.3 kgf-m, 16.5 lbf-ft)

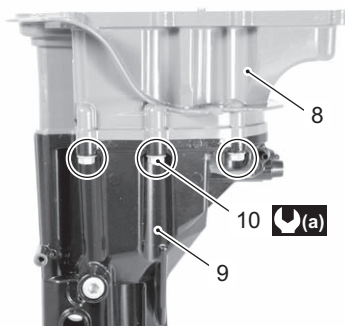

IDK111210071-01

Upper Mount

- Install the upper side mount (1).

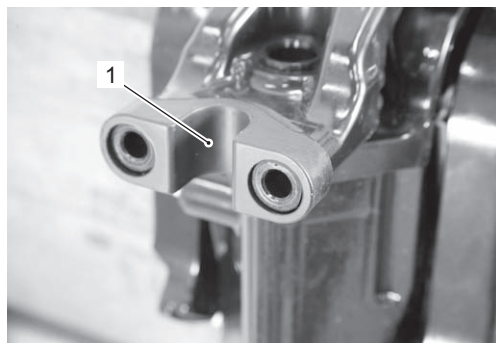

IDK111210072-01

- Assemble these items in the following sequence: Place the upper mount (2), upper mount cover (3) and thrust stopper (4) on upper mount bolts (5).

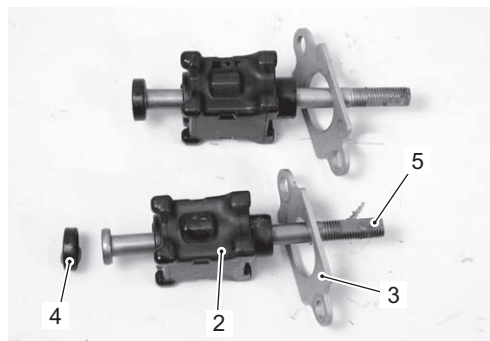

IDK111210073-01

- Place upper mount assembly into position.

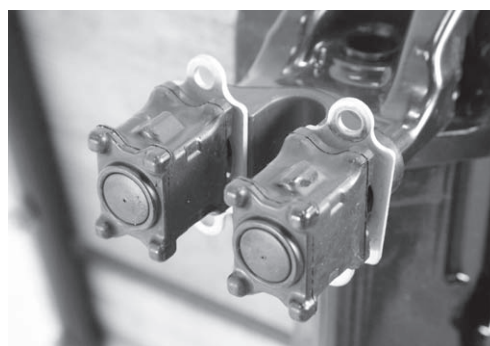

IDK111210074-01

- On PORT/STBD both sides: Install the washer (6) and upper mount nut (7), then tighten two nuts, pre-coated with thread lock, to specified torque.

Tightening torque

Upper mount nut (a): 35 N·m (3.5 kgf-m, 25.0 lbf-ft)

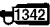
 : Thread lock cement 99000-32050 (SUZUKI Thread Lock 1342 (50 g))

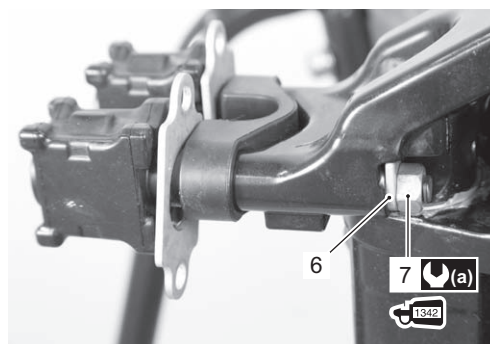

IDK111210075-01

Engine Holder and Driveshaft Housing

- Install the engine holder and driveshaft housing.
- Place the mount cover (1) into position, then tighten mount cover bolts (2), pre-coated with thread lock, to specified torque.

Tightening torque

Upper mount cover bolt (a): 23 N·m (2.3 kgf-m, 16.5 lbf-ft)

1342 : Thread lock cement 99000-32050 (SUZUKI Thread Lock 1342 (50 g))

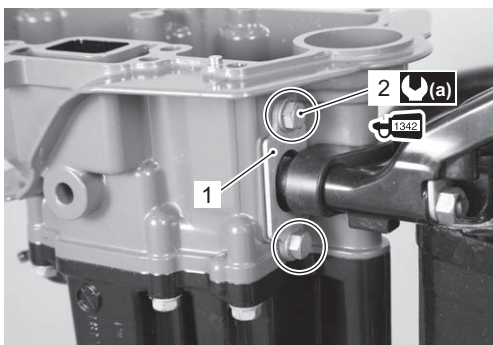

IDK111210076-01

Lower Mount and Lower Mount Cover

- Install the lower side mount (1), lower thrust mount (2) and pin (3) to PORT lower mount cover (4).

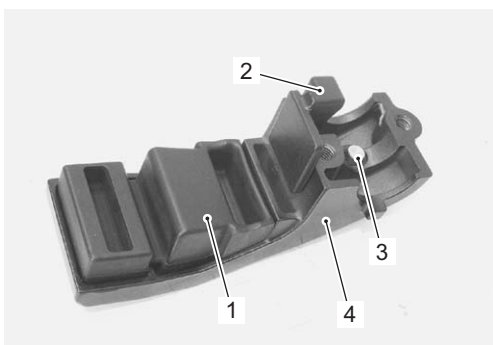

IAJ311210090-03

- Install the pilot shaft washer (5), then place PORT lower mount cover (with lower mount) to driveshaft housing and steering shaft.

NOTE

When attaching the lower mount cover to steering shaft, ensure that the retaining pin (3) properly fits into the hole "A" of steering shaft.

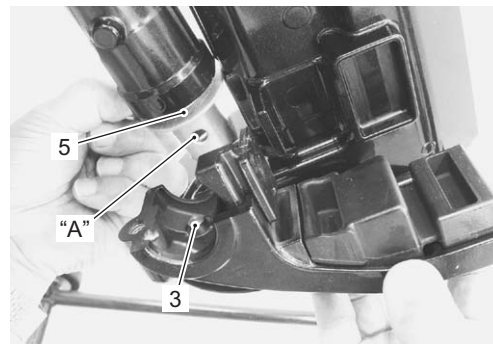

IAJ311210091-02



IAJ311210092-01

- Install the lower side mount (6), and pin (7) to STBD lower mount cover (8).

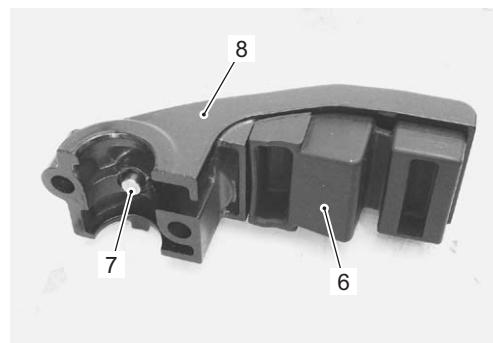

IAJ311210093-01

2A-18 Housing and Bracket:

- Install STBD lower mount cover (with lower mount) to driveshaft housing and steering shaft.

NOTE

When attaching the lower mount cover to steering shaft, ensure that the retaining pin (7) properly fits into the hole "A" of steering shaft.

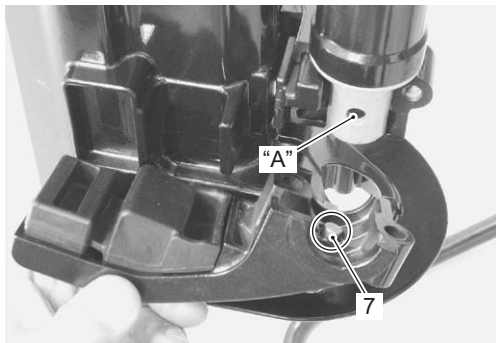

IAJ311210094-02

- Install the lower mount cover bolts, then tighten two bolts, pre-coated with thread lock, to specified torque.

Tightening torque

Lower mount cover bolt (a): 23 N·m (2.3 kgf-m, 16.5 lbf-ft)

 1342 : Thread lock cement 99000-32050 (SUZUKI Thread Lock 1342 (50 g))

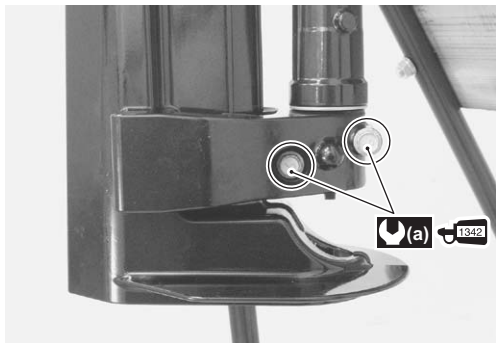

IAJ311210095-01

Engine Holder / Driveshaft Housing / Mounts Related Component Inspection

CENDK1112106011

Refer to "Engine Holder / Driveshaft Housing / Mounts Disassembly" (Page 2A-14) and "Engine Holder / Driveshaft Housing / Mounts Assembly" (Page 2A-15).

NOTE

If any component is found to be excessively worn, cracked, defective or damaged in any way, it must be replaced.

Engine Holder

- Inspect the engine holder. Replace if cracked, damaged, or other abnormal conditions are noted.
- Check water passage. If clogged or obstructed, clean water passage.

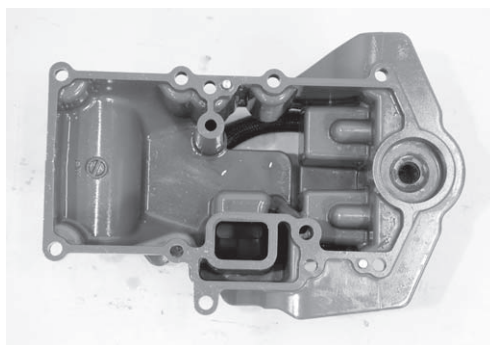

IDK111210077-01

Mount Cover

- Inspect the mount cover. Replace the mount cover if cracked, damaged or other abnormal conditions are found.

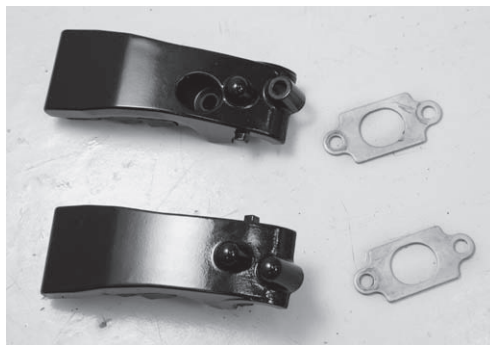

IDK111210078-01

Driveshaft Housing

- Check driveshaft housing.
If cracks, defects or other damage is found, replace it.



IDK111210079-01

Mount

- Check upper, lower and thrust mounts.
If excessive wear, corrosion or other damage is found, replace mount.
- Check mount bolts.
If cracks, corrosion or other damage is found, replace bolt.

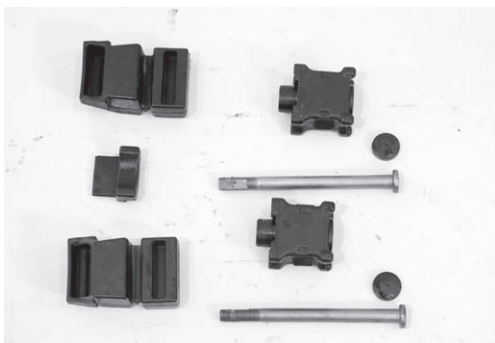

IDK111210080-01

Water Tube / Water Tube Grommet

- Check water tube.
If a clog or obstruction is found, clean water tube.
If cracks, corrosion or other damage is found, replace water tube.
- Check water tube grommet.
If excessive wear or other damage is found, replace grommet.

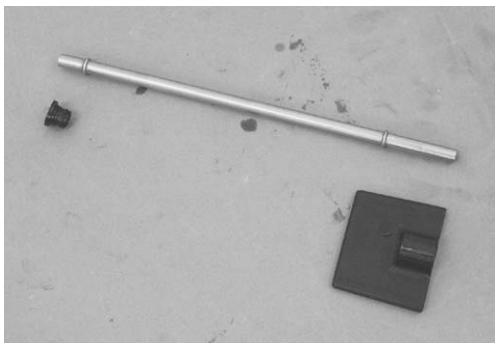

IAJ311210100-01

Driveshaft Upper Oil Seal Replacement

CENDK1112106012

- 1) Remove the engine holder.
Refer to “Engine Holder / Driveshaft Housing / Mounts Disassembly” (Page 2A-14).
- 2) Extract oil seal with flat blade screw driver.

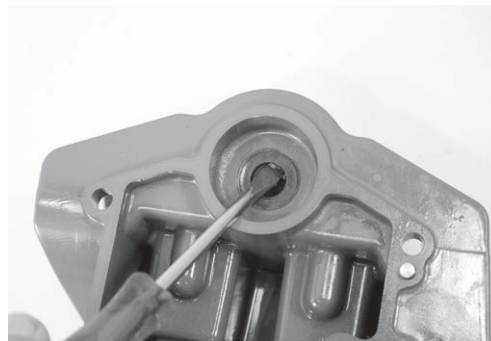

IDK111210081-01

- 3) Apply water resistant grease to outer circumference of oil seal.
- 4) Drive the oil seal into the engine holder.

NOTE

Install oil seal with lip (spring side) facing downward (oil pan side).

 : Grease 99000-25350 (SUZUKI Water Resistant Grease EP2 (250 g))

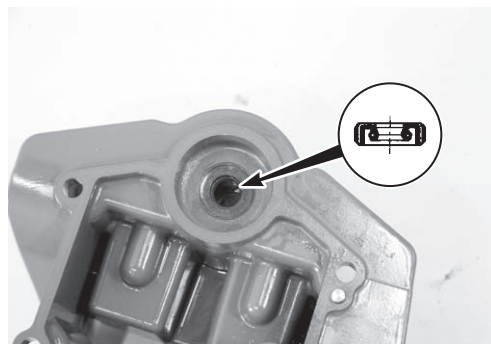

IDK111210082-01

- 5) Reassemble the engine holder.
Refer to “Engine Holder / Driveshaft Housing / Mounts Assembly” (Page 2A-15).

Clamp / Swivel / Steering Brackets Components

CENDK1112106013

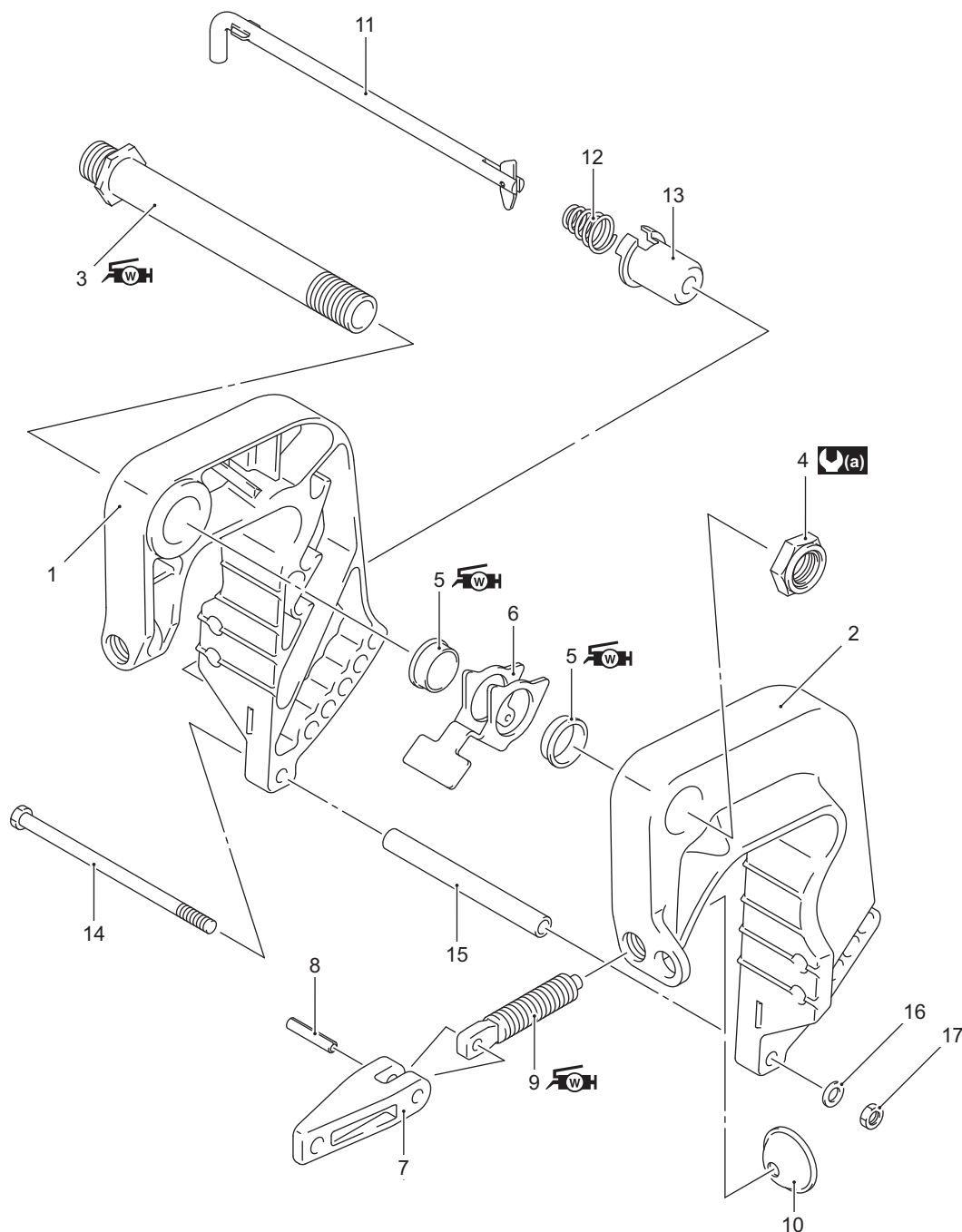

IDK111210013-03

1. Clamp bracket STBD	6. Release lever	11. Tilt pin	16. Washer
2. Clamp bracket PORT	7. Clamp handle	12. Spring	17. Nut
3. Clamp bracket shaft	8. Pin	13. Stopper	(a) : 43 N·m (4.3 kgf-m, 31.0 lbf-ft)
4. Nut	9. Clamp screw	14. Bolt	: Apply SUZUKI water resistance grease.
5. Bush	10. Clamp plate	15. Spacer	: Apply SUZUKI thread lock 1342.

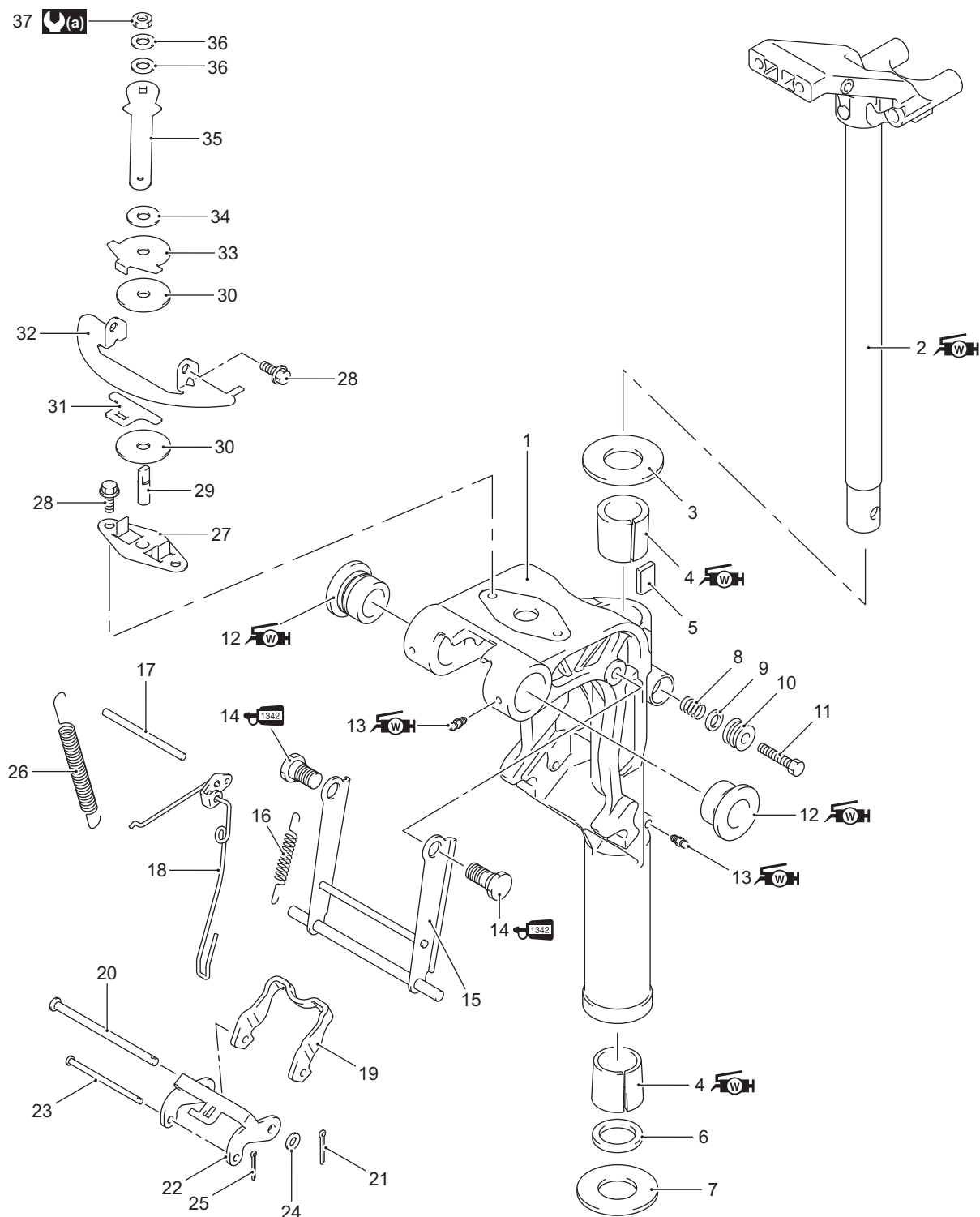

IDK111210014-03

1. Swivel bracket	11. Bolt	21. Cotter pin	31. Spacer
2. Steering bracket	12. Bush	22. Reverse lock arm link	32. Steering adjuster plate
3. Washer	13. Grease nipple	23. Pin	33. Upper plate
4. Bush	14. Bolt	24. Washer	34. Washer
5. Plate	15. Shallow drive arm	25. Pin	35. Adjuster lever
6. Seal	16. Spring	26. Spring	36. Washer
7. Washer	17. Pin	27. Friction plate	37. Nut
8. Spring	18. Release link	28. Bolt	(a) : 9 N-m (0.9 kgf-m, 6.5 lbf-ft)
9. Washer	19. Reverse lock arm	29. Shaft	: Apply SUZUKI water resistance grease.
10. Cover	20. Pin	30. Washer	: Apply SUZUKI thread lock 1342.

Clamp / Swivel / Steering Brackets Disassembly

CENDK1112106014

- 1) Remove engine holder / driveshaft housing.
Refer to "Engine Holder / Driveshaft Housing / Mounts Disassembly" (Page 2A-14).
- 2) Remove the two bolts (1) and handle bracket (2).

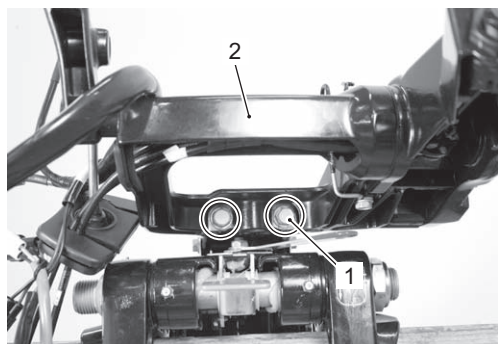

IDK111210083-01

- 3) Remove the bolts (3) and steering adjuster assembly (4).

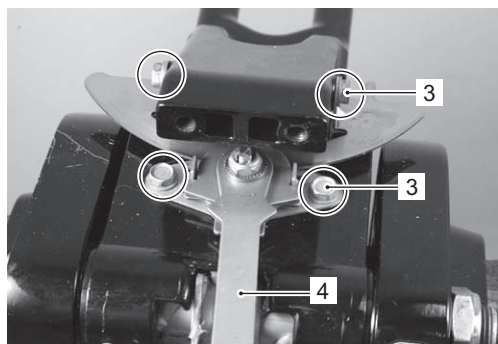

IDK111210084-01

- 4) Remove the steering adjuster bolt (5), cover (6), washer (7) and spring (8).

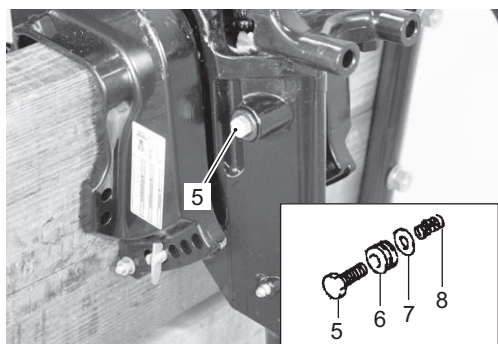

IDK111210085-01

- 5) Lift steering bracket (9) upward to remove from swivel bracket.
Remove the washer (10), upper bush (11) from swivel bracket.

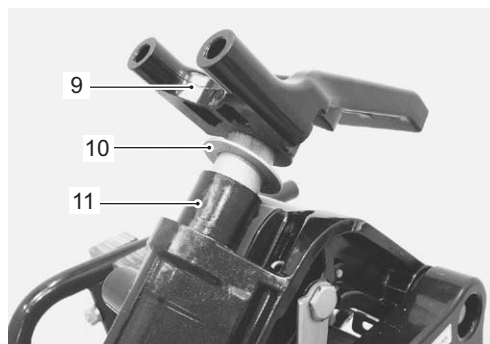

IAJ311210106-01

- 6) Remove the swivel bracket seal (12) and lower bush (13).

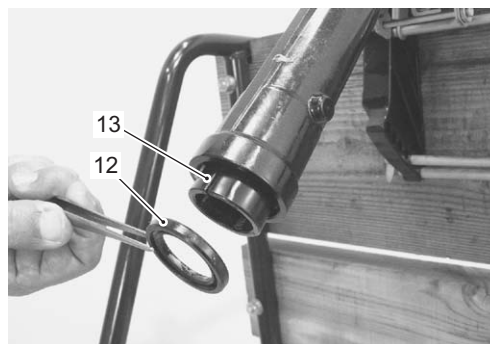

IAJ311210107-01

- 7) Remove the steering adjuster plate (14).

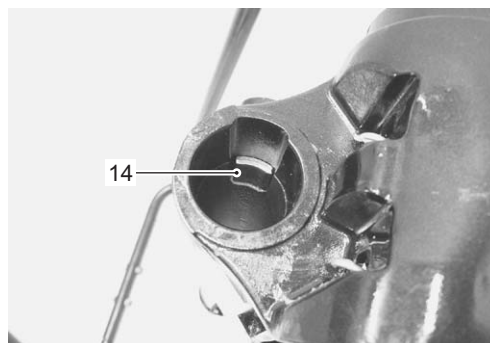

IAJ311210108-01

- 8) Remove the nut (15) from clamp bracket shaft.

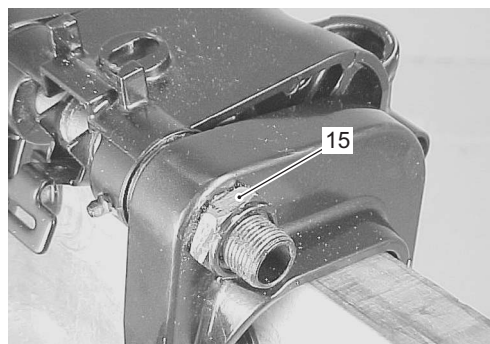

IAJ311210110-01

- 9) Remove the tilt lock pin (16).
Remove the nut (17), bolt (18) and spacer (19).

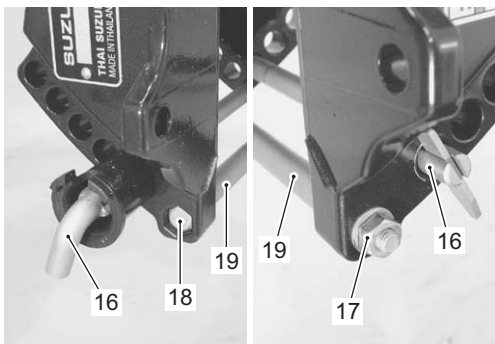

IAJ311210111-01

- 10) Remove the PORT clamp bracket (20).

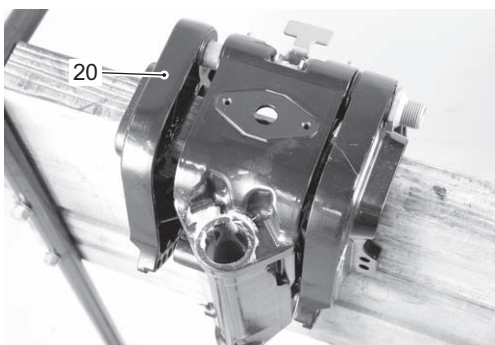

IDK111210009-02

- 11) Pull STBD clamp bracket (21) outward to remove clamp bracket and bracket shaft (22) from swivel bracket (23). Remove bushings (24) from each side of swivel bracket.

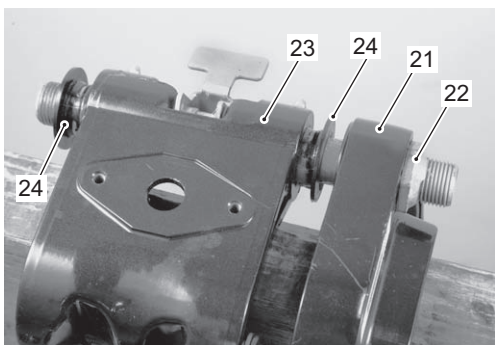

IDK111210086-01

- 12) Remove the spring (25).
Remove two bolts (26) and shallow drive arm (27).

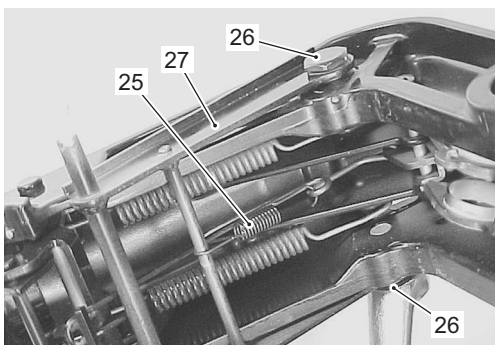

IAJ311210007-02

- 13) Remove two springs (28) from reverse lock arm (29) and pin (30).

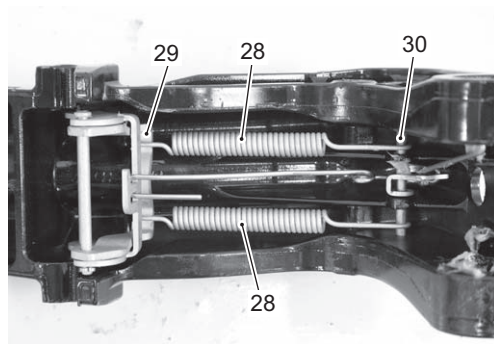

IDK111210087-01

- 14) Remove the release arm pin (30) and release link (31).

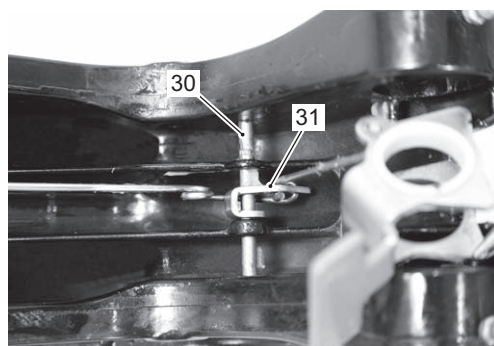

IDK111210088-01

- 15) Remove the cotter pin (32), washer (33), pin (34) and reverse lock arm link (35).
Remove the cotter pin (36), pin (37) and reverse lock arm (38).

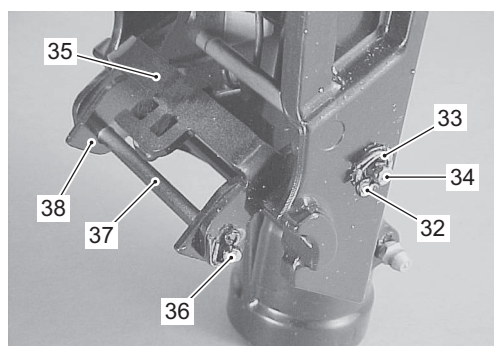

IDK111210089-01

2A-24 Housing and Bracket:

Clamp / Swivel / Steering Brackets Assembly

CENDK1112106015

Assembly is reverse order of disassembly with special attention to the following steps.

Shallow Drive Arm

- Install shallow drive arm (1).
- Tighten the shallow drive arm bolts (2), pre-coated with thread lock, to specified torque.

Tightening torque

Shallow drive arm bolt (a): 25 N·m (2.5 kgf-m, 18.0 lbf-ft)

 : Thread lock cement 99000-32050 (SUZUKI Thread Lock 1342 (50 g))

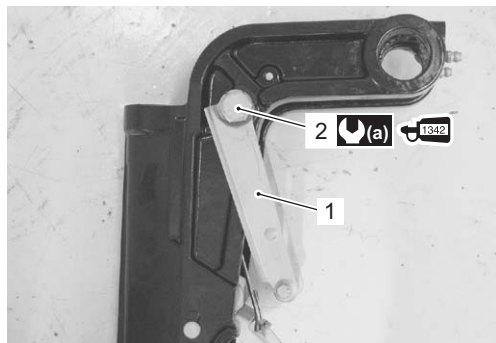

IAJ311210116-01

- Install the arm spring (3) as shown.

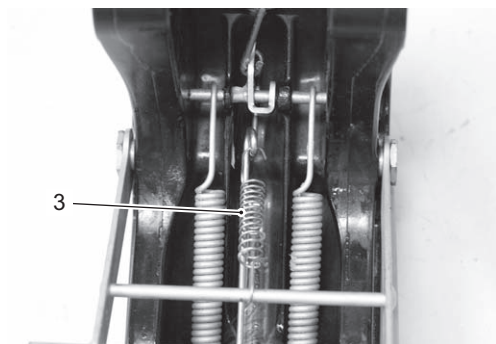

IDK111210090-01

Clamp Bracket and Swivel Bracket

NOTE

Before installing clamp bracket to swivel bracket, apply grease to clamp bracket shaft and bushings.

 : Grease 99000-25350 (SUZUKI Water Resistant Grease EP2 (250 g))

- 1) Connect the release link (1) to release lever (2).

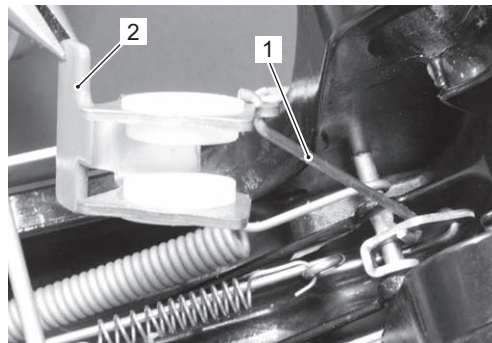

IDK111210091-01

- 2) Insert PORT and STBD bushings (3) into the swivel bracket (4).

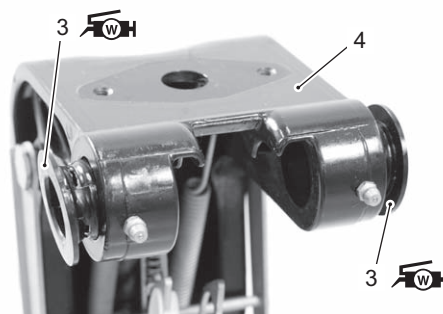

IDK111210092-01

- 3) Assemble the clamp bracket shaft (5), STBD clamp bracket (7), release lever (2), bushings (8) and swivel bracket (4).

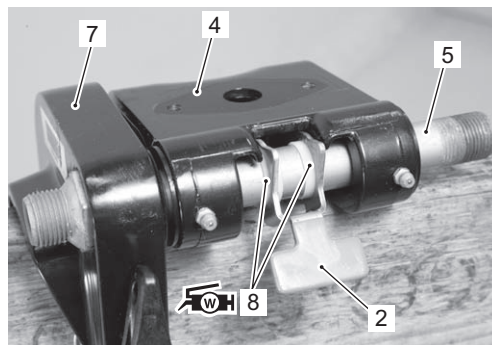

IDK111210093-01

- 4) Install PORT clamp bracket (9).

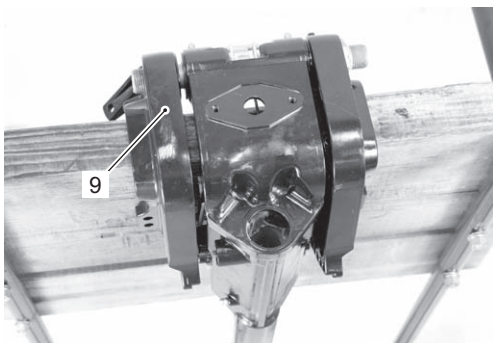

IDK111210094-01

- 5) Install the clamp bracket shaft nut (10), then tighten the clamp bracket shaft nut to specified torque.

Tightening torque

Clamp bracket shaft nut (a): 43 N·m (4.3 kgf-m, 31.0 lbf-ft)

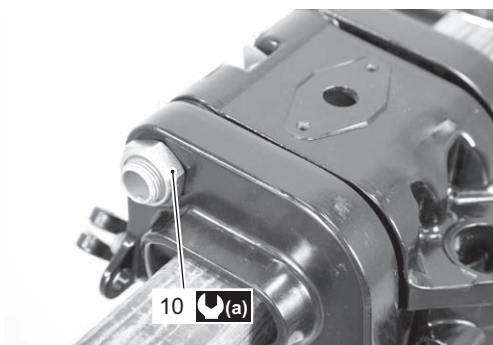

IDK111210010-03

Steering Bracket

- 1) Install the steering adjuster plate (1) to swivel bracket.

 : Grease 99000-25350 (SUZUKI Water Resistant Grease EP2 (250 g))

NOTE

Apply grease to bushings, seal and pilot shaft portion of steering bracket.

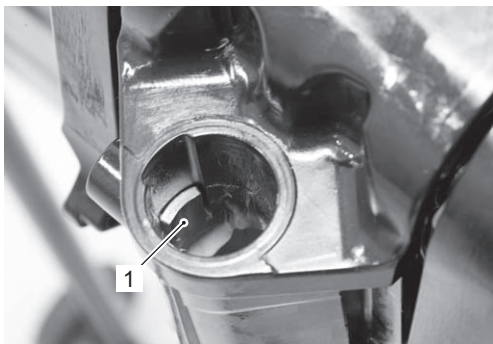

IDK111210095-01

- 2) Install the upper bushing (2) and washer (3) to swivel bracket.

NOTE

- The bushing (2), (4) outside face is tapered. Install the bushing into the swivel bracket with the smaller diameter side being inserted first.
- Be certain that steering adjuster (1) is placed between upper bushing (2) and swivel bracket casing.

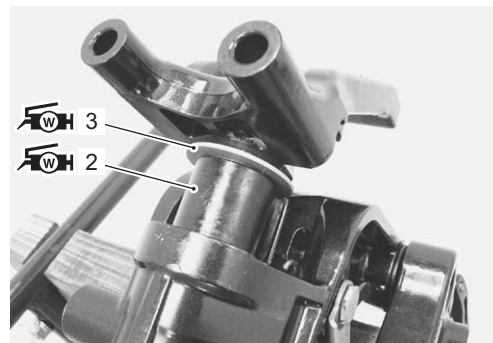

IAJ311210127-01

- 3) Install the lower bushing (4) and swivel bracket seal (5) to swivel bracket.

NOTE

Install bracket seal (5) with oil seal lip (spring side) facing downward

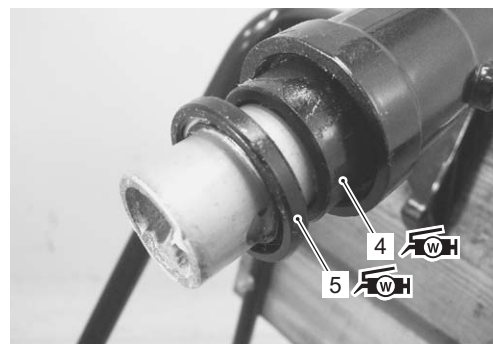

IAJ311210128-01

2A-26 Housing and Bracket:

Handle Bracket

- 1) Install the steering friction adjuster (1).
Refer to "Steering Friction Adjuster Disassembly and Assembly" (Page 2A-5).

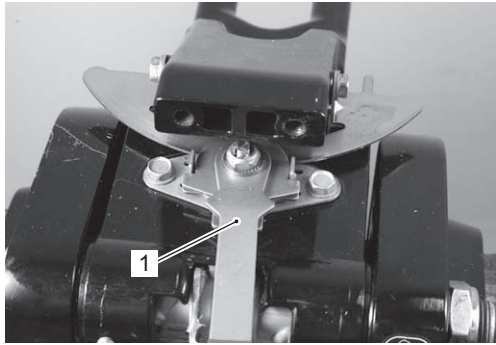

IDK111210096-01

- 2) Install the handle bracket (2) to steering bracket, then securely tighten it with bolts (3).

Tightening torque

Handle bracket bolt (a): 23 N·m (2.3 kgf-m, 16.5 lbf-ft)

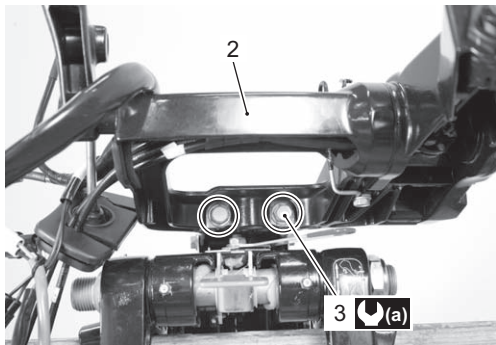

IDK111210097-01

Lubrication

After completing reassembly of the mid unit, apply grease through each grease nipple.

 : Grease 99000-25350 (SUZUKI Water Resistant Grease EP2 (250 g))

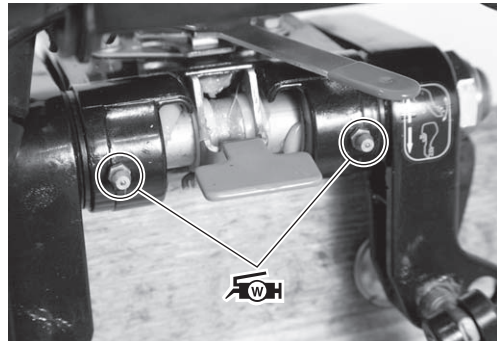

IDK111210098-01

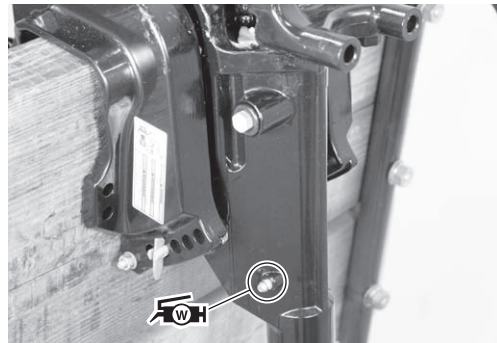

IDK111210099-01

Clamp / Swivel / Steering Brackets Related Components Inspection

CENDK1112106016

Refer to "Clamp / Swivel / Steering Brackets Disassembly" (Page 2A-22) and "Clamp / Swivel / Steering Brackets Assembly" (Page 2A-24).

NOTE

If any component is found to be excessively worn, cracked, defective or damaged in any way, it must be replaced.

Bushings

Check all bushings. If excessive wear or other damage is found, replace bushing. If bushing fit is loose when installing, replace bushing.



IDK111210100-01

Oil Seal

Check swivel bracket seal. If excessive wear or other damage is found, replace seal.



IAJ311210134-01

Clamp Bracket Shaft

Check clamp bracket shaft.

If clamp bracket shaft is bent or twisted, replace shaft.



IDK111210101-01

Bracket

Check clamp brackets, steering bracket and swivel bracket.

If cracks or other damage is found, replace bracket (s).



IDK111210102-01

