

SV SERIES SEA-COCKS

FEATURES

- ✓ Marine U/L Listed
- ✓ Bronze Castings
- ✓ Expanding Buna-N Rubber valve plug — no valve to plug freeze
- ✓ Full pipe size flow
- ✓ Drain plug included

INSTALLATION

- ✓ Screw onto an appropriately sized bronze thru-hull fitting and use (2) 3/8" diameter bolts to secure valve to hull or butt block.
- Valve should be positioned so as to drain when drain plug is removed.
- ✓ Use a sealant between valve flange and hull or butt block.

OPERATION

- ✓ Loosen wingnut and turn handle vertically to open and horizontally to close. Hand-tighten wingnut each time.

NOTE: While wingnut is loose while opening or closing valve, some leakage is normal, but will stop when wingnut is retightened.

CARE AND MAINTENANCE

If, after several seasons of operation the valve becomes more difficult to operate, some light lubrication may be necessary. At haul-out have the valve plug removed, greased, and replaced. At the factory, #4000 Drydene Lubricant is used for initial assembly.

WINTERIZATION

To properly winterize the valve, simply close valve (don't forget to hand tighten wingnut), and remove the drain plug. When water is drained replace and tighten drain plug.

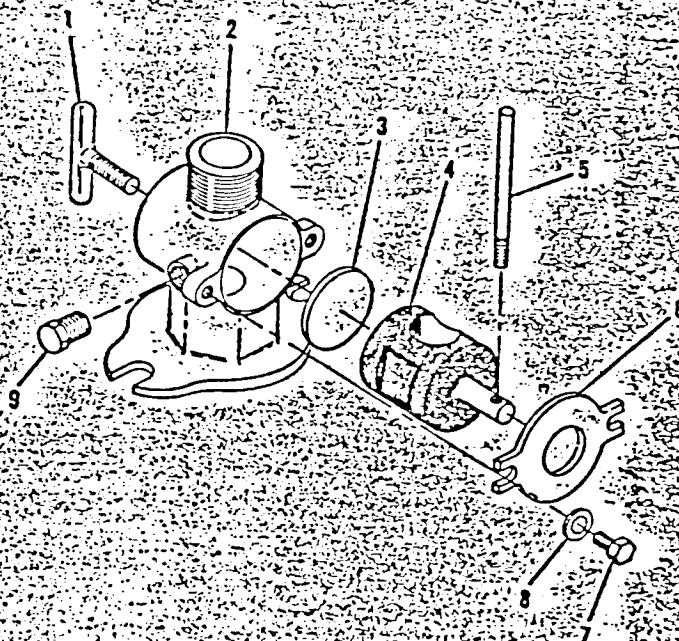
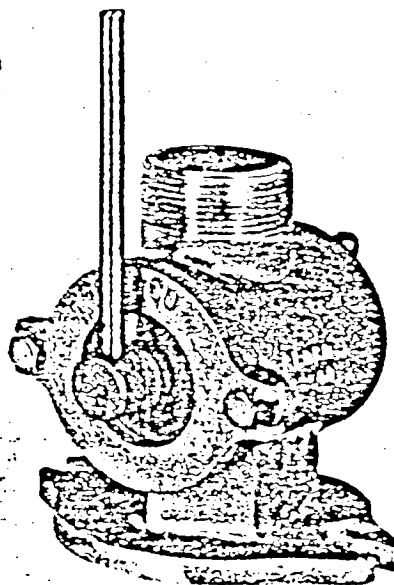

VALVE	PIPE SIZE	HEIGHT	WEIGHT
SV-500	1/2"	2-3/8"	14 oz.
SV-750	3/4"	4-1/2"	1 lb., 14 oz.
SV-1000	1"	5"	2 lb., 8 oz.
SV-1250	1-1/4"	5-3/4"	3 lb., 8 oz.
SV-1500	1-1/2"	7"	5 lb.
SV-2000	2"	8"	10 lb., 5 oz.
SV-2500	2-1/2"	10"	15 lb., 6 oz.

ITEM	NAME	SV-500	Qty.	SV-750	Qty.	SV-1000	Qty.	SV-1250	Qty.	SV-1500	Qty.	SV-2000	Qty.	SV-2500	Qty.
1	Wingnut	SV-502	1	SV-752	1	SV-752	1	SV-1502	1	SV-1502	1	SV-2502	1	SV-2502	1
2	Body	SV-500	1	SV-750	1	SV-1000	1	SV-1250	1	SV-1500	1	SV-2000	1	SV-2500	1
3	Disc	SV-503	1	SV-753	1	SV-103	1	SV-1253	1	SV-1503	1	SV-2003	1	SV-2503	1
4	Plug	SV-506	1	SV-756	1	SV-1006	1	SV-1256	1	SV-1506	1	SV-2006	1	SV-2506	1
5	Handle	SV-506-A	1	SV-756-A	1	SV-1006-A	1	SV-1256-A	1	SV-1506-A	1	SV-2006-A	1	SV-2506-A	1
6	Cover	SV-501	1	SV-751	1	SV-101	1	SV-1251	1	SV-1501	1	SV-2001	1	SV-2501	1
7	Screws	1/4x1/2 HB	2	1/4x1/2 HB	2	1/4x1/2 HB	2	1/4x1/2 HB	2	1/4x1/2 HB	2	1/4x1/2 HB	4	1/4x1/2 HB	4
8	Lockwashers	1/4 ET	2	1/4 ET	2	1/4 ET	2	1/4 ET	2	1/4 ET	2	1/4 ET	4	1/4 ET	4
9	Drain Plug	1/8-27	1	1/8-27	1	1/8-27	1	1/8-27	1	1/8-27	1	1/8-27	1	1/8-27	1

Since 1910 GROCO has been manufacturing, what we sincerely believe to be the best in the industry in such items as described in our catalog.

We are proud of our tradition of original design and unsurpassed quality of materials and workmanship. But perhaps the most significant contribution to our success has been the fact that we have made a conscious effort not to expand more rapidly than our capabilities could handle. We feel that there is a point at which a company's efficiency decreases as its size

increases. At GROCO "efficiency" and customer satisfaction go hand in hand. We measure our success in number of loyal satisfied customers, not just in the sales dollar.

We are proud of GROCO and the job we've done; and we're happy to serve you.

Donald Groco
PRESIDENT

- NEW FOR 1983 -

- ✓ ARG Raw Water Strainers — A new series of raw water strainers (replacing our SA series) featuring simplified installation and service, construction without tie rods, and a reduced price. (see page 12)
- ✓ SW-2531 — a spanner wrench for use with ARG or SD series raw water strainers. (see page 17)
- ✓ MX3 Valve Manifold System — A manifold system for use with SPO-30-R or SP-50-R pumps to aid in engine oil changing. (see page 20)
- ✓ SPO-30 — A heavy-duty, reversible (or non-reversible), self-priming pump for engine oil change, deck wash or diesel fuel transfer. (see page 19, 21)

- ✓ Flo-Master Pumps are available with pump-mounted variable speed control to control flow rate, and toggle switch on-off control. (see individual pump pages)
- ✓ PTH Fittings — A complete line of bronze fittings which simplify plumbing when connecting hose to raw water strainers. (see page 17)
- ✓ CP-20-V Variable Speed Circulating Pump
- ✓ SPO-30-R Oil Change Pump Kit
- ✓ SP-50-V Variable Speed Self-Priming Utility Pump

- ON THE DRAWING BOARD -

- ✓ WS-300 Automatic Water Pressure System — A self-priming system with vane-type pump
- ✓ WS-400 Automatic Water Pressure System — A centrifugal turbine pump with whisper quiet operation

- ✓ VDA and HDB Raw Water Strainers — Our VD and HD strainers will be updated, reflecting the same improvements as our ARG strainers.

- GROCO LIMITED WARRANTY -

PRODUCTS COVERED BY THIS WARRANTY: All lines of products manufactured by GROCO.

The warranty of a manufacturer reflects his confidence in the quality of his materials and workmanship.

GROCO will repair or replace any part of any of its products which is found to be defective by the factory (or an authorized GROCO repair center) within one year* of the o.e.m. installation date or the distributor's original date of sale provided that:

1. The product has been properly installed and used in accordance with the instructions packed with the product.
2. No repairs or replacements have been made without written factory authorization.
3. Proof of purchase can be supplied (receipt or invoice).
4. The product is under original ownership.
5. The product is properly packed to prevent shipping damage and shipped freight paid directly to the factory (or delivered to an authorized GROCO repair center).
6. The product has not been misused, abused, or altered in any way.

GROCO products are designed and manufactured with the most durable materials available for resistance to the corrosive and electrolytic effects of salt water application. This does not mean, however, that the product will last indefinitely without proper care and maintenance. The manufacturer recommends regular weekly inspection (frequency of inspections may vary

with frequency of use) of all parts of its products for signs of wear and/or deterioration of any kind and, when necessary, replacement of worn parts with genuine GROCO parts. Failure to inspect regularly and/or replace worn parts when necessary constitutes neglect on the part of the owner, and could cause damage to or failure of the product itself, or the entire unit (your boat), of which this unit is a part. Neglect voids product warranty. The following conditions are not covered by this warranty:

1. Repairs or adjustments made by other than factory personnel, or authorized GROCO repair center personnel.
2. Using the product to perform duties other than those for which the product was intended.
3. Deterioration of the product due to the introduction of chemicals not intended for use with the product.
4. Winter freeze-up due to improper winterization and care.
5. The use of the product under extreme temperature or pressure conditions.
6. The jamming or clogging of the product with foreign matter which the product is not intended to handle.
7. Products found to be operating properly by factory personnel or authorized GROCO repair center personnel.
8. Physically damaged or altered products (including fraying of motor leads and the removal of product stickers and labels).

*Certain products may have special warranty conditions which are outlined in the product instruction sheet.