

INSTALLATION INSTRUCTIONS

ELECTRICAL GAUGES

DIGITAL DISPLAY

08 #

TACHOMETER

<p>1</p> <p>RED - TO IGNITION SWITCH 12V(+) BLACK - TO BATTERY(-) GREEN - ON STANDARD COIL IGNITION* ATTACH WIRE TO NEGATIVE(-)SIDE OF COIL</p> <p>ON ELECTRONIC IGNITION CONNECT GREEN WIRE TO THE TACHOMETER PULSE OUTPUT</p>	<p>2</p>	<p>3</p>	<p>4</p>
<p>5</p>	<p>6</p>	<p>7</p> <p>*ON ELECTRONIC IGNITIONS, SUCH AS HEI, MSD, OR CRANE, CONNECT GREEN WIRE TO TACH OUTPUT TERMINAL ONLY! WARNING: FAILURE TO COMPLY WITH ABOVE WILL CAUSE DAMAGE.</p>	<p>8</p>

VOLTMETER

<p>1</p> <p>RED - TO IGNITION SWITCH 12V(+) BLACK - TO BATTERY(-) NOTE: THE GAUGE HAS A RED WARNING LIGHT. IT WILL LIGHT UP WHEN VOLTS DROP BELOW 11.5</p>	<p>2</p>	<p>3</p>	<p>4</p>
<p>5</p>	<p>6</p>	<p>7</p>	<p>8</p>

OIL/WATER TEMPERATURE GAUGE

<p>1</p> <p>RED - TO IGNITION SWITCH 12V(+) BLACK - TO BATTERY(-) GREEN - TEMP SENSOR NOTE: THE GAUGE HAS A RED WARNING LIGHT. IT WILL LIGHT UP WHEN WATER TEMP IS OVER 100 CENTIGRADES</p>	<p>COMMON CONNECTION OF TEMP SENDER UNIT TO ENGINE. IN MOST CASES A "T-PIECE FITTING" (NOT SUPPLIED) CAN BE USED IN PLACE OF THE ORIGINAL TEMP SENDER SO THAT THE TWO SENDER UNITS CAN BE ATTACHED.</p>	<p>2</p>	<p>3</p>
<p>4</p>	<p>5</p>	<p>6</p>	<p>7</p>

NOTE: THE ABOVE TACHOMETER OPERATES ON A STANDARD, FACTORY ELECTRONIC AND HIGH PERFORMANCE ELECTRONIC RACING IGNITION IN MOST CASES.

INSTALLATION INSTRUCTIONS

ELECTRICAL GAUGES

DIGITAL DISPLAY

08 #

BOOST/VACUUM GAUGE

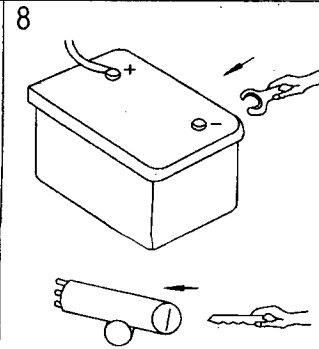
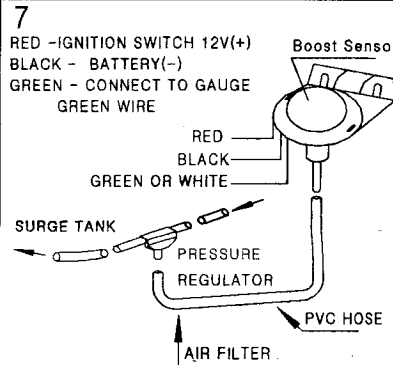
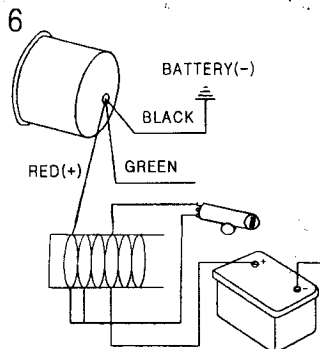
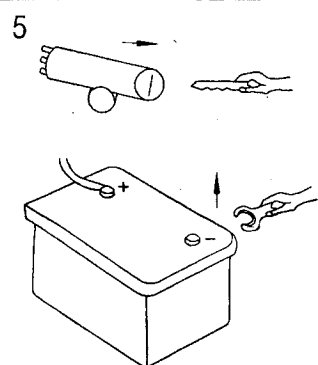
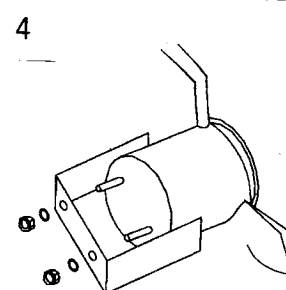
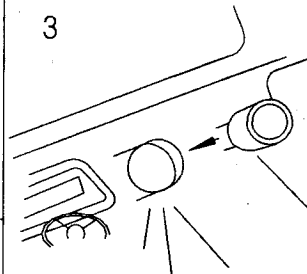
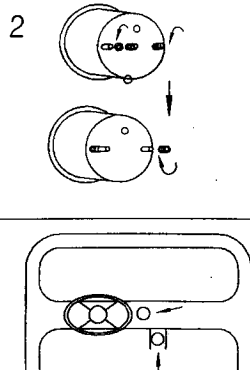
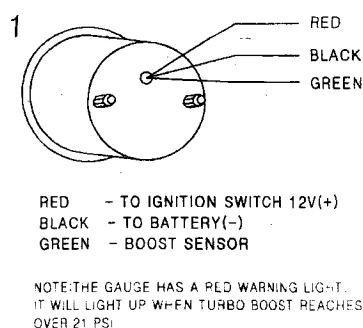

OIL PRESSURE GAUGE

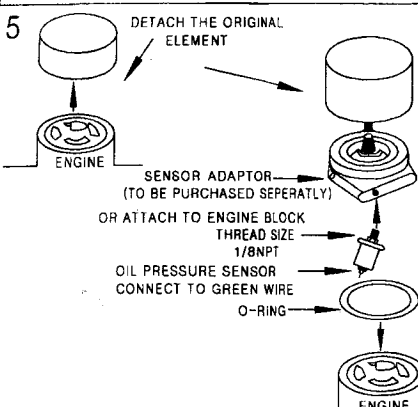
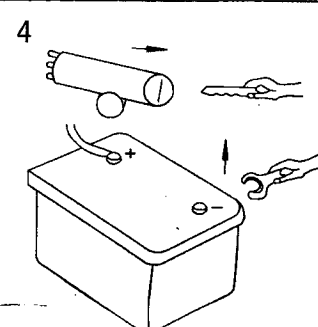
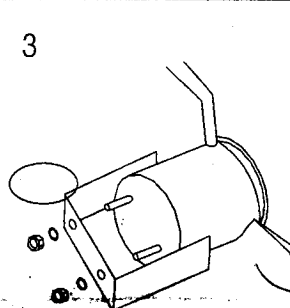
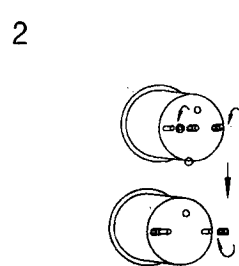
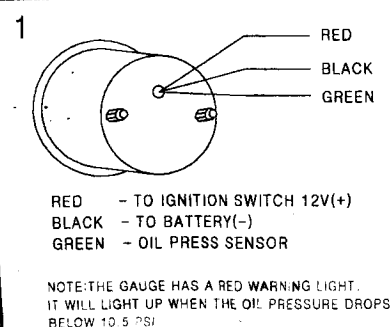

COMMON CONNECTION OF OIL GAUGE UNIT TO ENGINE. IN MOST CASES A "T-PIECE FITTING" (NOT SUPPLIED) CAN BE USED IN PLACE OF THE ORIGINAL OIL GAUGE SENDER SO THAT THE TWO SENDER UNITS CAN BE ATTACHED.

GLOWSHIFT® **INSTALLATION INSTRUCTIONS**

Tech Support
856-768-8300 EXT 2
TechSupport@GlowShiftGauges.com

PERFORMANCE GAUGES & PODS

Digital Series Transmission Temperature Gauge

For Product Numbers: GS-BD12 and GS-RD12

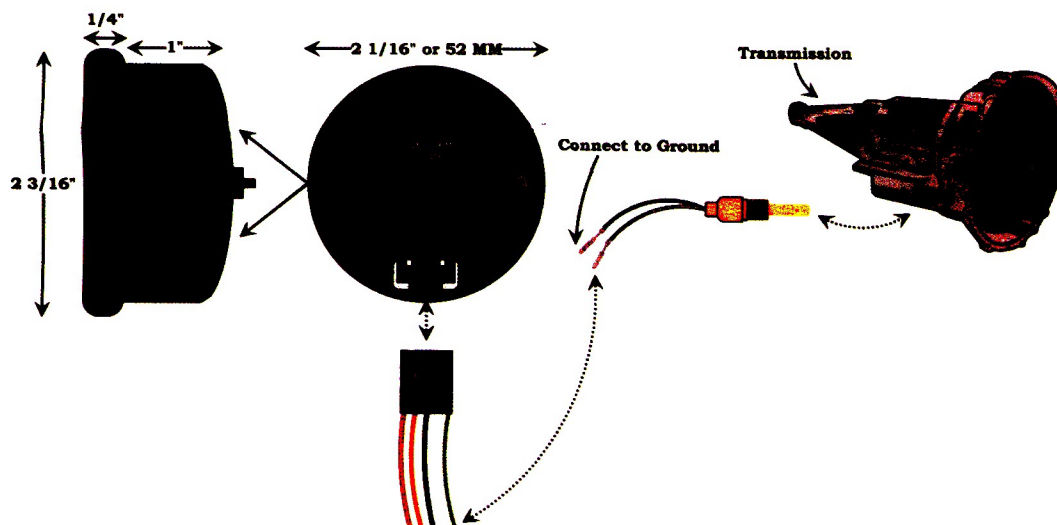

Wire Color Code	
Red: 12v Ignition Source (+) (switched)	Orange: 12v Switched Headlamp Source (+) (optional)
Black: Vehicle Ground (-)	Green: Connects to the White Wire on the Temperature Sensor

1. Disconnect the vehicle's negative battery cable.

Temperature Sensor Installation

2. There are two common types of transmission temperature sensor installations:

- **Transmission Test Port:** Most vehicle transmissions come equipped with a test port location. This may be located on either the driver or passenger sides of the transmission near the transmission oil pan. The bolt in this port should be removed and the sensor fitted in its place. Confirm port and thread size with your vehicle dealer or owner's manual. A test port extender will be required when installing this sensor into Dodge Ram model years 94-07.5
- **Stock Sensor Location:** Use a T-fitting (optional) to T off your stock sensor location. This will allow you to keep your stock sensor installed, while also allowing you to install an aftermarket temperature sensor.

Note: Some vehicles may require additional adapters to complete the installation of this sensor.

Connecting the Power Wire Harness

3. To make the wiring of your gauges easier you can purchase an *expandable circuit*. This component easily fits into your fuse panel and provides an additional fused power wire for accessories such as gauges. The expandable circuit is available for purchase at www.GlowShift.com.

4. Connect the **green wire** from the gauge to the **white wire** of the transmission temperature sensor. Then, connect the **black wire** of the transmission temperature sensor to any good (unpainted) ground connection.

5. Using automotive grade wiring (18 gauge); connect the **red wire** to a positive 12 volt **ignition (switched)** source. It may be connected to the fuse panel, an accessory wire, or any positive 12 volt source that turns on and off with the ignition.

6. Using automotive grade wiring (18 gauge); connect the **black wire** to any good (unpainted) ground connection. You may also route a wire directly to the negative side of the vehicle's battery.

7. The Night Time Dimming feature decreases the brightness of the gauge face by 30%. Connect the **orange wire** to the 12 volt positive headlamp source. This allows the mode to be activated when the headlights come on. This step is optional and will not affect operation of the gauge if it is omitted.

- **Note:** Do not connect the orange wire to a dimmer wheel. This will cause the gauge lighting to flicker.

8. Reconnect the vehicle's negative battery cable.